

**Audi > C5 > 1998-2005**

**Engine Mechanical**

**17 - Lubrication system components, removing and installing**

**Oil pressure and oil pressure switch, checking**

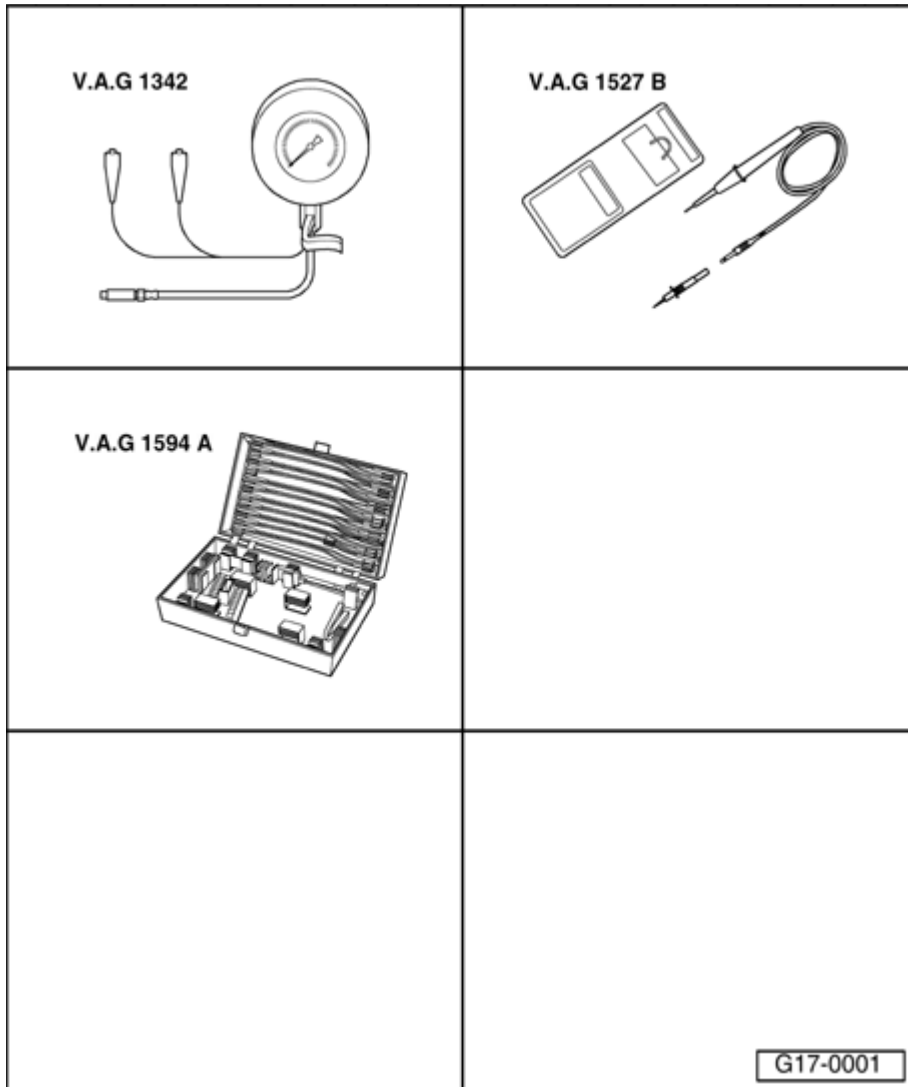

**Special tools, testers and auxiliary items required**

- ♦ oil pressure gauge VAG1342
- ♦ VAG1527B
- ♦ VAG1594A

**Requirements**

- ♦ Oil level OK
- ♦ Engine oil temperature approx. 80 °C.

- With ignition on, Oil pressure warning light K3 must be lit.
- For vehicles with Auto Check System, "OK" indicator must be lit (call up symbol).

### **Oil pressure switch, checking**

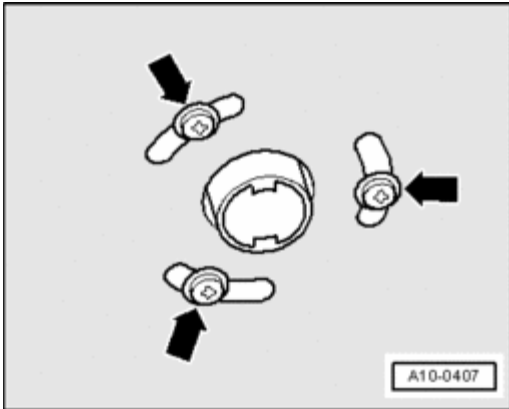

- For vehicles with auxiliary heater, remove bolts (arrows) for exhaust pipe of parking heater/auxiliary heater at sound insulation.

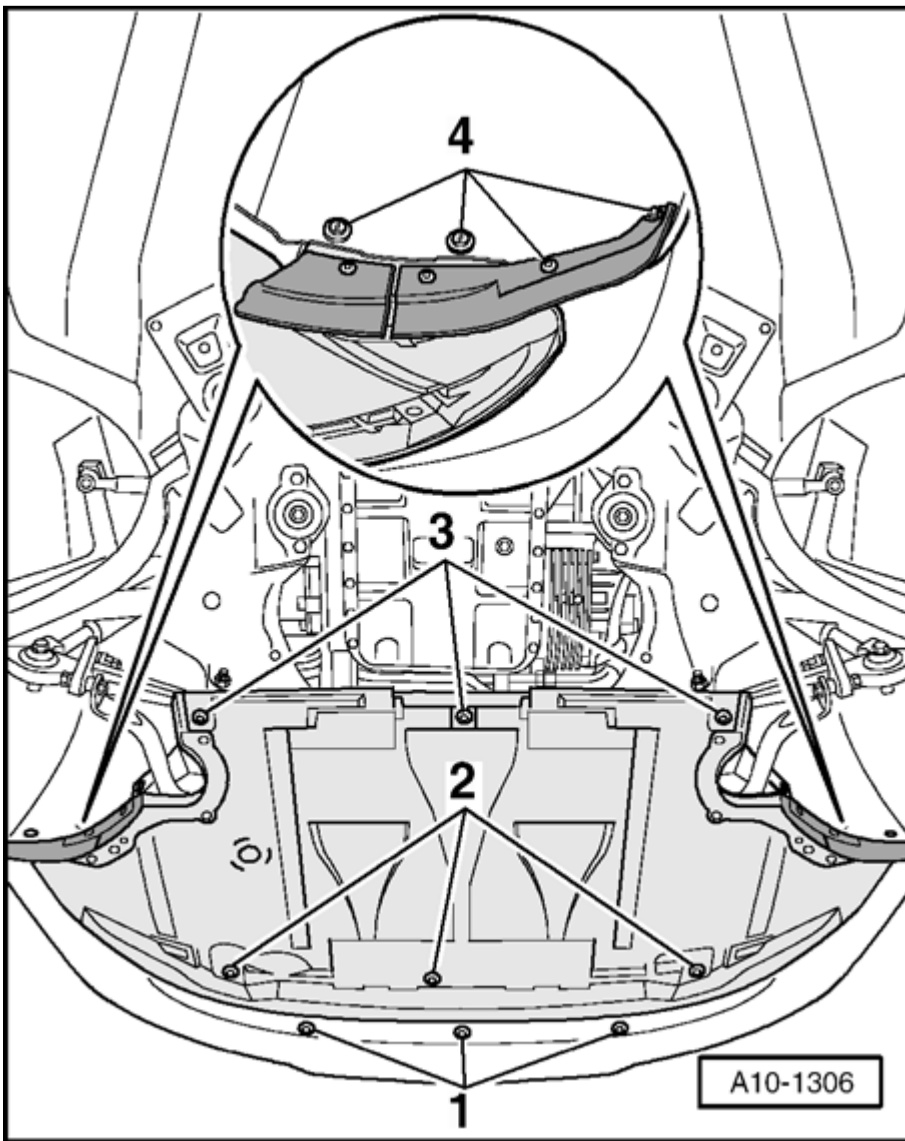

- Loosen mounting parts -1 to 4- and remove sound insulation.

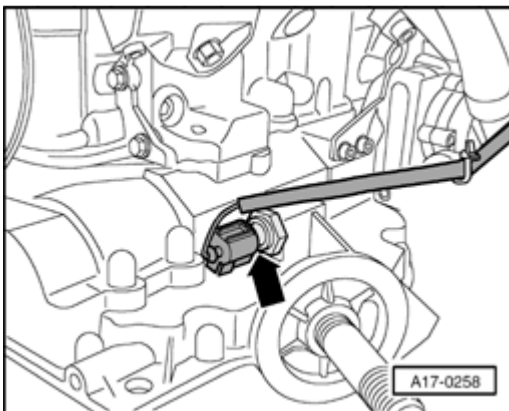

- Disconnect electrical harness connector from oil pressure switch (arrow).

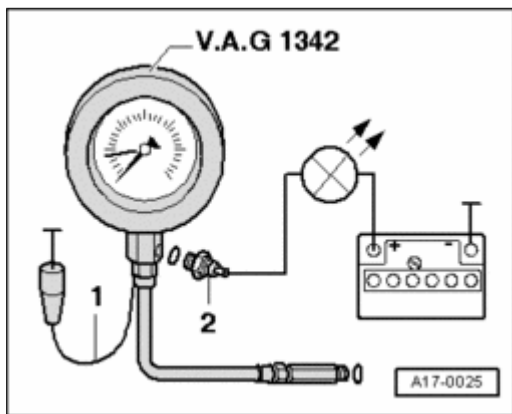

- Unscrew oil pressure switch and install oil pressure tester VAG1342 .
- Thread oil pressure switch - **2** - into oil pressure tester VAG1342 .
- Connect brown wire - **1** - of tester to Ground (GND).
- Using connect test kit VAG1594A , connect voltage tester VAG1527B to oil pressure switch and Battery (+).

✦ LED must not be lit.

If LED is lit:

- Replace oil pressure switch.
- Start engine.

**Note:**

✦ *While starting engine, watch pressure tester and LED as oil pressure switch may open during start.*

**Black oil pressure switch**

✦ 1.2 to 1.6 bar pressure, LED must light up

If LED does not light up:

- Replace oil pressure switch.

**Oil pressure, checking**

- Disconnect electrical wire from oil pressure switch.

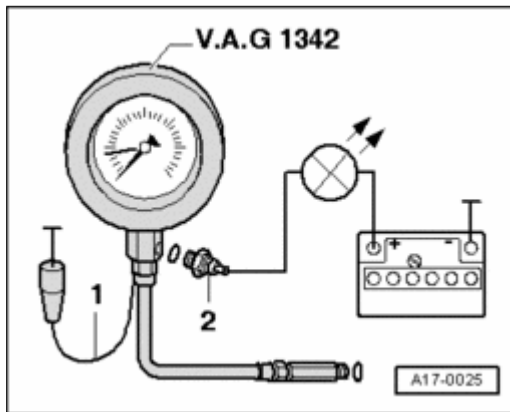

- Unscrew oil pressure switch and install oil pressure tester VAG1342 .
  - Thread oil pressure switch - **2** - into oil pressure tester VAG1342 .
  - Start engine (engine oil temperature approx. 80 °C).
  - ✦ Oil pressure at idle: at least 1.5 bar
  - ✦ Oil pressure at 2000 RPM: at least 3.0 bar
- If specified values are not obtained:
- Pressure relief valve or oil pump faulty, replace oil pump.

*Copyright © 2006 Audi of America, Inc. and Bentley Publishers. All rights reserved. Last processed:*