

2 Rear lid

2.1 Removing and installing rear lid and rear lid lock

1 - Rear lid

- Removing:



Note

A second mechanic is required to support and lift off the rear lid.

- Remove hazard warning triangle with holder ⇒ [Item 5 \(page 15\)](#).
- Remove rear lid lining.
- Disconnect and unclip wires.
- Unscrew nuts for connecting both hinges to rear lid ⇒ [page 18](#).

- Install in reverse order.

- Adjusting:

- Adjust rear lid in vertical and horizontal directions by way of rear lid hinge ⇒ [page 18](#).
- Adjust buffer stops ⇒ [Item 2 \(page 14\)](#).
- Adjust striker pin ⇒ [Item 6 \(page 15\)](#).
- Centrally align rear lid in accordance with joint dimensions ⇒ [page 16](#).
- Adjusting ⇒ [page 16](#)

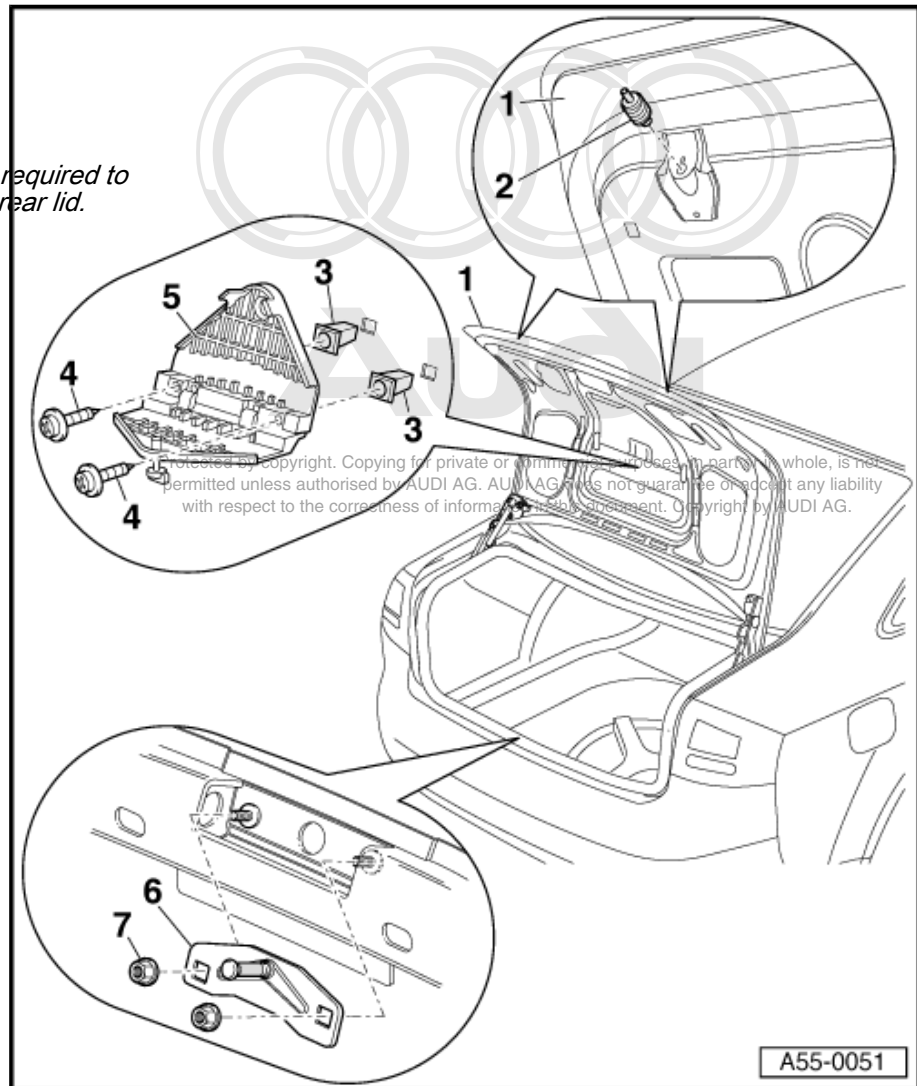

2 - Buffer stop (2x)

- Adjusting:

- Rear lid is set with respect to side panel by way of striker plate.

- Use Phillips screwdriver to press home spring pin.
- Turn spring pin anti-clockwise to lock.
- Screw buffer stops into rear lid.
- Carefully close rear lid until it is flush with rear side panel.
- Gradually screw out buffer stops.
- Given correct adjustment, buffer stops must rest lightly on sill with rear lid closed.
- Turn spring pin clockwise with Phillips screwdriver to release.

3 - Expanding nut

4 - Self-tapping screw - 1.5 Nm

5 - Holder

- To remove, take out hazard warning triangle, unscrew bolts ⇒ [Item 4 \(page 15\)](#) and detach holder.

6 - Striker plate

- Unscrew nuts ⇒ [Item 7 \(page 15\)](#) .
- Adjusting:
 - Hand-tighten nuts ⇒ [Item 7 \(page 15\)](#) (it must still be possible to move striker pin).
 - Carefully close rear lid until it is flush with rear side panel.
 - Carefully open rear lid and tighten nuts ⇒ [Item 7 \(page 15\)](#) .

7 - Hexagon nut - 8 Nm

2.2 Removing and installing rear lid lock and handle mechanism

1 - Rear lid lock

- Swivel out hinged lever ⇒ [Item 2 \(page 15\)](#) of operating rod ⇒ [Item 4 \(page 15\)](#) and disengage from rear lid lock.
- Unscrew hexagon nuts ⇒ [Item 3 \(page 15\)](#) and detach rear lid lock.

2 - Hinged lever

- Swivel over operating rod after installing rear lid lock.

3 - Hexagon nut - 8 Nm

4 - Operating rod

5 - Hexagon nut - 8 Nm

6 - Handle mechanism

- Removing:
 - Remove rear lid trim.
 - Unclip operating rod ⇒ [Item 4 \(page 15\)](#) from handle mechanism.
 - Unscrew nuts ⇒ [Item 5 \(page 15\)](#) and take out handle mechanism.

7 - Actuator

- Removing ⇒ [page 17](#)

8 - Lock cylinder

- Removing:
 - Remove handle mechanism.
 - Remove operating lever ⇒ [page 17](#) .

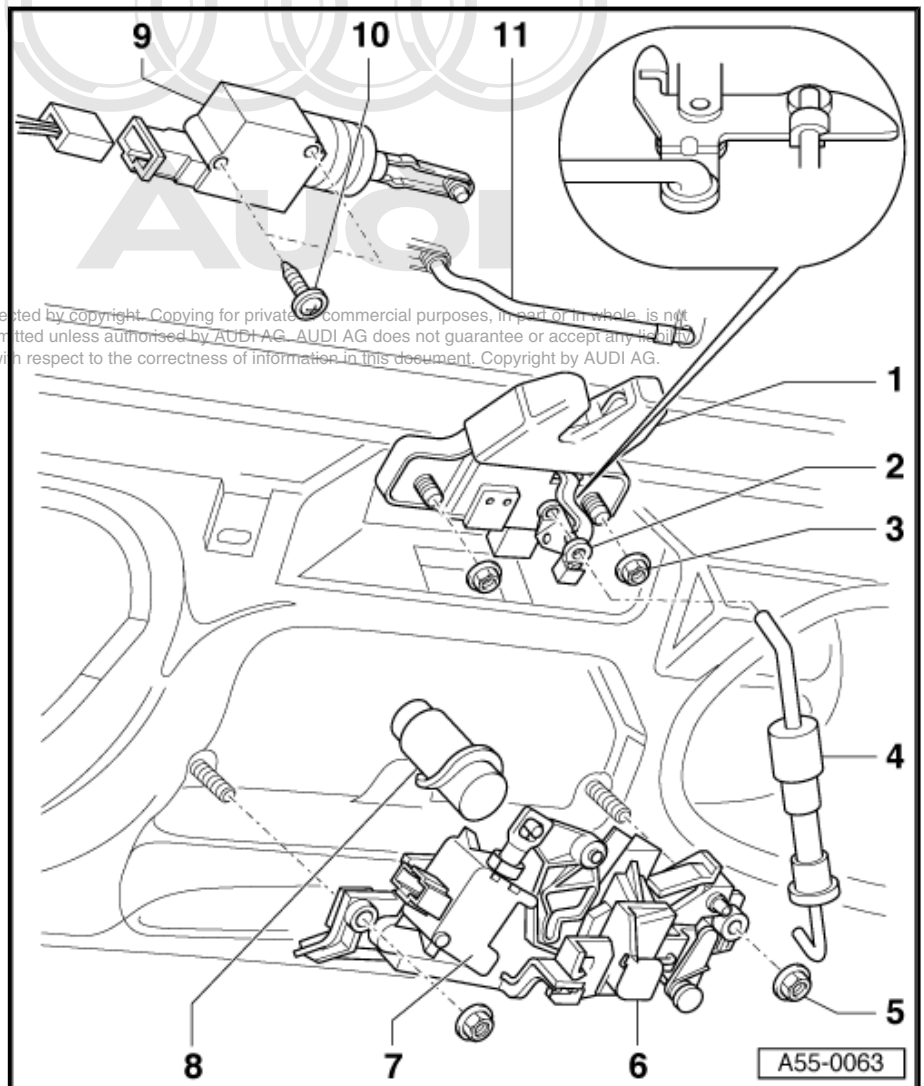



- Take lock cylinder out of handle mechanism.

9 - Remote release motor

- Removing and installing ⇒ [page 17](#)

10 - Bolt - 1.2 Nm

11 - Operating rod

2.3 Adjusting rear lid

Special tools and workshop equipment required

- ◆ Adjustment gauge -3371-

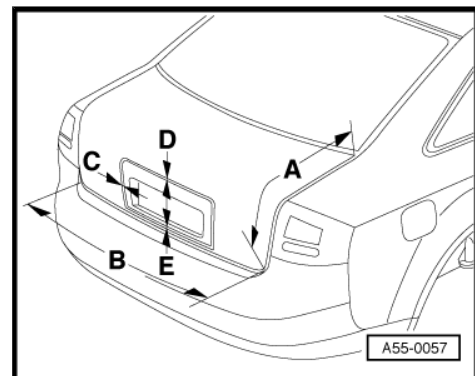
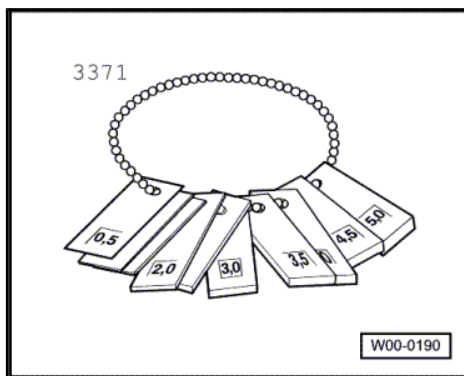

Joint dimensions

- Dimension -A- = 3 mm + 1 mm
- Dimension -B- = 5 mm + 1 mm
- Dimension -C- = 1.5 mm ± 0.3 mm
- Dimension -D- = Flush with rear lid
- Dimension -E- = 1.5 mm - 5 mm

Adjusting rear lid

- Remove trim for rear cross panel ⇒ General body repairs, interior; Rep. Gr. 70 .



Note

Gas-filled struts must be fitted before adjusting new rear lid.

- Unfasten nuts -1-; it must be possible to move striker plate -2-.
- Carefully close rear lid until it is flush with side panel.
- Carefully open rear lid and tighten nuts -1- to 8 Nm.

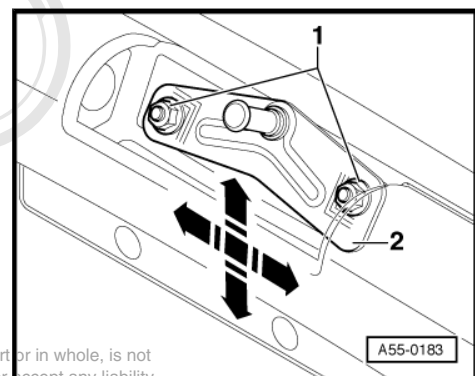

Protected by copyright. Copying for private or commercial purposes, in part or in whole, is not permitted. Audi AG does not guarantee or accept any liability with respect to the correctness of information in this document. Copyright by AUDI AG.

2.4 Removing and installing remote release motor

- Unclip operating rod -3-.
- Unscrew (1.2 Nm) bolts -2- (2x).
- Unplug connector from remote release motor -1-.

Note

- ◆ Operating rod -4- need not be unclipped from hinged lever -5-.
- ◆ Prior to installation in rear lid, connector must be plugged in at motor.

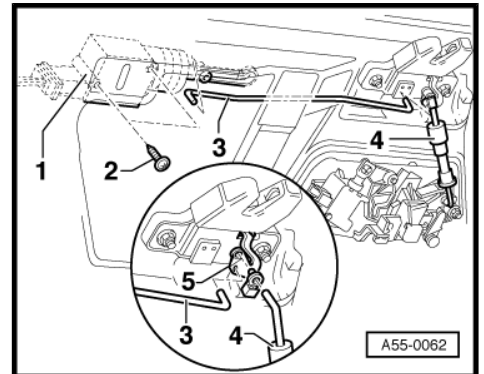

2.5 Removing and installing rear lid actuator

1 - Release handle

- Unfasten catch and pull out release handle.

2 - Seal

3 - Actuator

- Removing:
 - Remove rear lid trim.
 - Remove locking system.
 - Use screwdriver to press in fastener at left operating lever ⇒ [Item 1 \(page 17\)](#) in -direction of arrow A- and thus release catch.
 - Pull left operating lever ⇒ [Item 1 \(page 17\)](#) downwards out of handle mechanism ⇒ [Item 4 \(page 17\)](#)
 - Unscrew cross-head bolts -arrows B- and detach actuator.

4 - Handle mechanism

- Removing ⇒ [Item 6 \(page 15\)](#)

5 - Lock cylinder

- Moulded seal

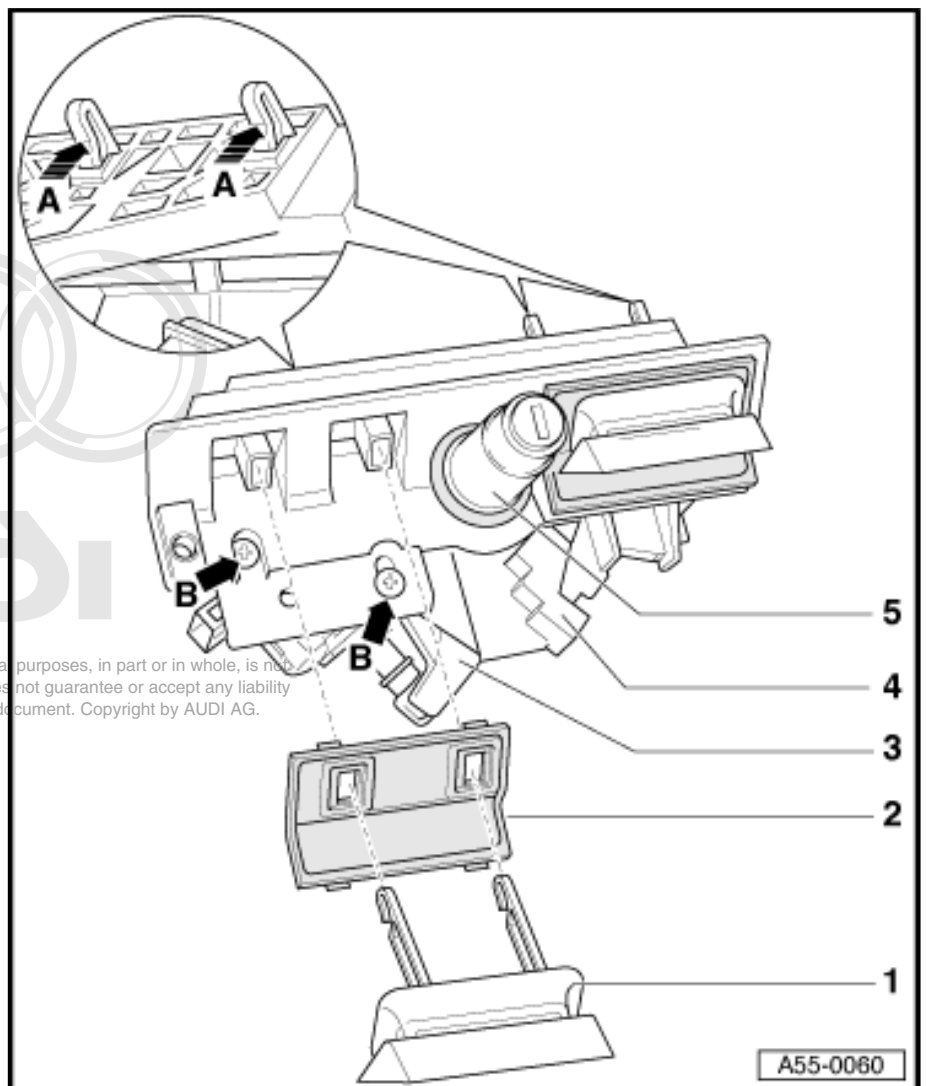

Protected by copyright. This document or commercial purposes, in part or in whole, is not permitted unless a written permission is granted by Audi AG. Audi AG does not guarantee or accept any liability with respect to the correctness of information in this document. Copyright by AUDI AG.

2.6 Removing and installing rear lid hinge

Cover for rear lid hinge

- Insert wire or tube for central locking -2- as shown in cover -1-.
- Engage trim -1- for rear lid hinge from underneath between gas-filled strut -3- and hinge lever and clip upwards onto hinge lever (can be heard to engage).

4 - Torx bolt - 8 Nm

5 - Stop

6 - Pop rivet nut

7 - Torx bolt - 8 Nm

9 - Pop rivet nut

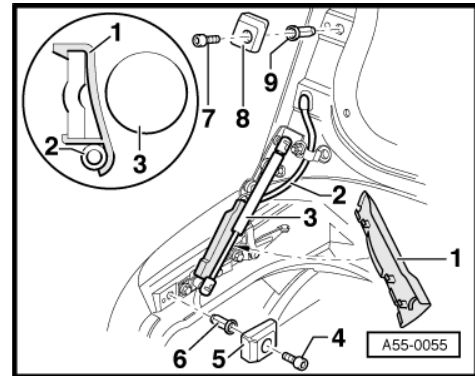

Removing and installing rear lid hinge

- Unfasten (21 Nm) nut -2- at top left and right.
- Unscrew (21 Nm) nut -2- at bottom left and right.
- Lift rear lid -4- off hinge.
- Unscrew bolts -7- at front and rear (2x).
- Only slacken off centre bolt (21 Nm).
- Detach hinge -1-.



Note

Protected by copyright. Copying for private or commercial purposes, in part or in whole, is not permitted unless authorised by AUDI AG. AUDI AG does not guarantee or accept any liability with respect to the correctness of information in this document. Copyright by AUDI AG.

When adjusting the rear lid, the scales -8- at the hinge and rear lid facilitate adjustment of the rear lid hinge.

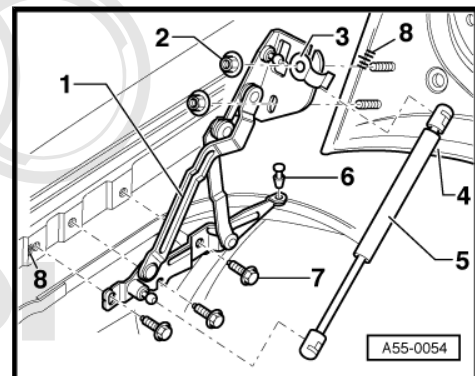

2.7 Removing and installing gas-filled strut

- Use screwdriver to slightly press back retaining springs at both ends of gas-filled strut and unclip gas-filled strut.



Note

When removing or installing gas-filled strut, push back open rear lid slightly, taking care not to damage components.

- Clip in gas-filled strut at bottom and then at top.
- Gas-filled strut cylinder -5- is installed at rear lid end.

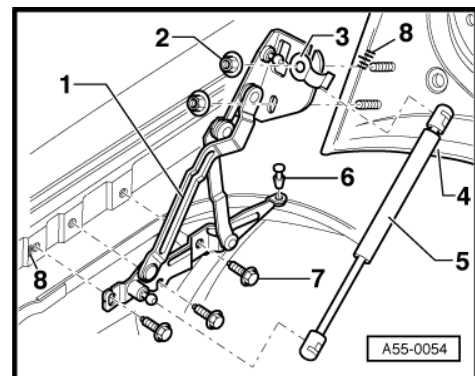

Releasing gas from gas-filled strut

WARNING
Only clamp strut in this area to avoid risk of accident.

- Clamp gas-filled strut in vice in area -x- = 50 mm.
- Cover saw cut area with a cloth to catch fluid escaping.

WARNING
Wear safety goggles whilst sawing.

- Saw open cylinder of gas-filled strut in first third of overall cylinder length, based on reference edge at piston rod end.

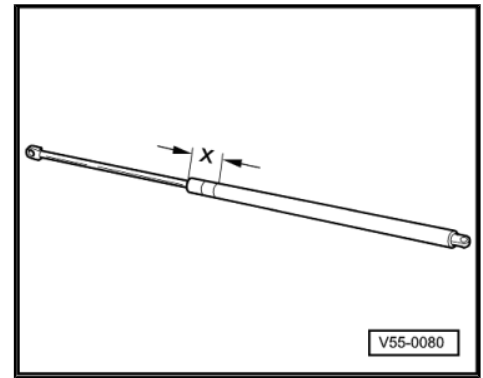

2.8 Installing rear lid seal

- Joint -A- of rear lid seal must be aligned with ball socket -arrow- of left hinge.
- Press on seal.

Protected by copyright. Copying for private or commercial purposes, in part or in whole, is not permitted unless authorised by AUDI AG. AUDI AG does not guarantee or accept any liability with respect to the correctness of information in this document. Copyright by AUDI AG.

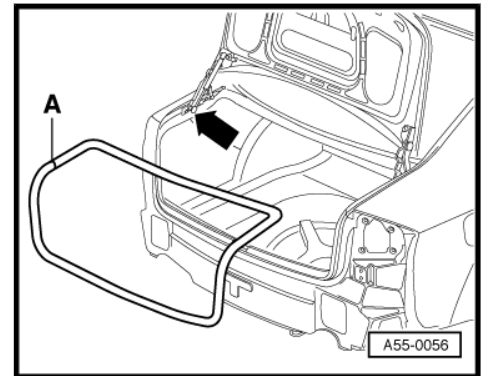

2.9 Adjusting buffer stops

- Open rear lid.
- Use Phillips screwdriver to insert spring pin in -direction of arrow-.
- Turn spring pin anti-clockwise -arrow A- to lock.
- Screw home buffer stops.
- Gradually screw buffer stops back out again.
- Given correct adjustment, buffer stops must rest lightly on sill with rear lid closed.
- Turn spring pin clockwise -arrow B- to release.

