

Oil pressure and oil pressure switch, checking

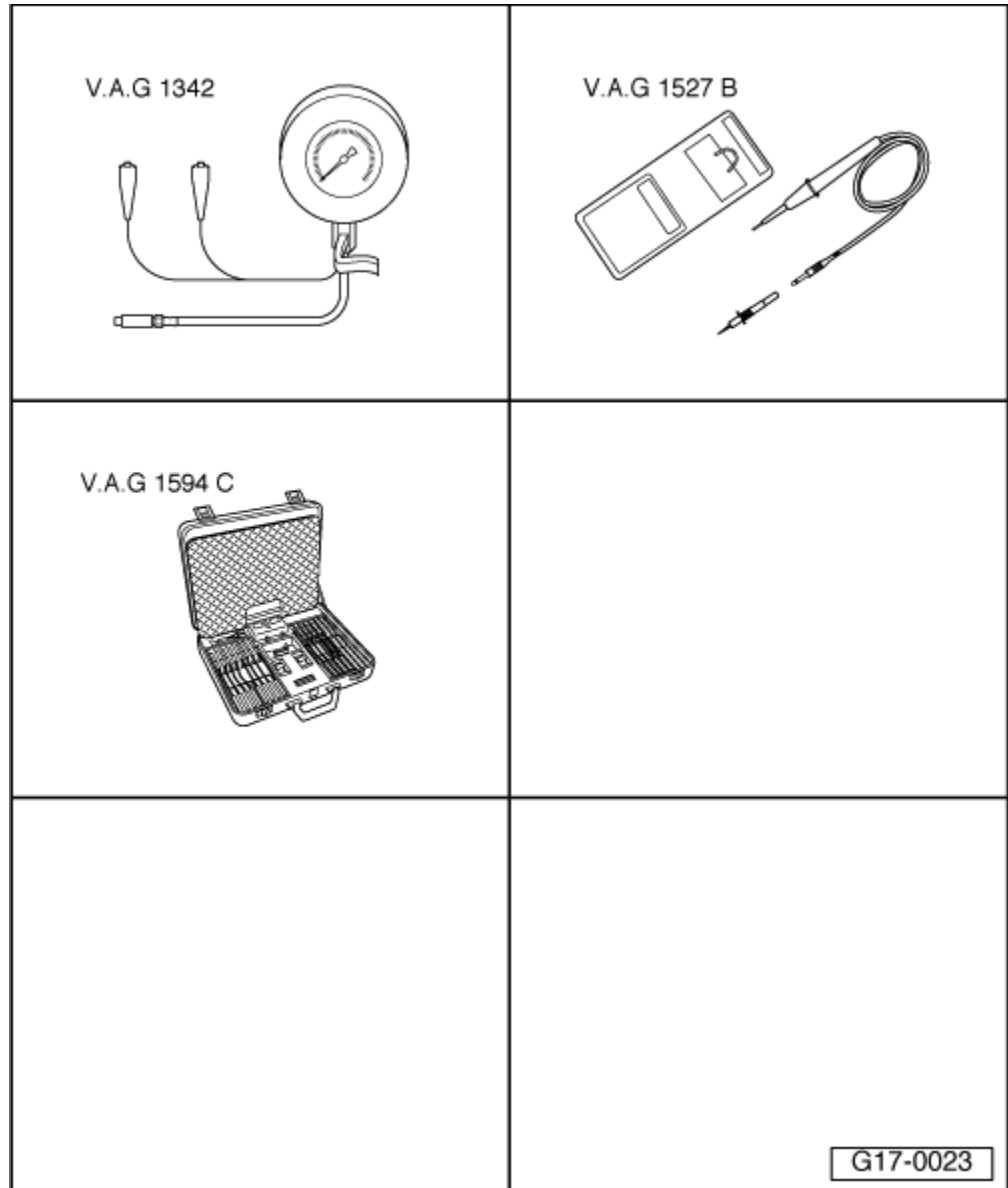

Special tools and workshop equipment required

- ◆ Oil pressure gauge -V.A.G 1342- with adapter -V.A.G 1342/14-
- ◆ Voltage tester -V.A.G 1527 B-
- ◆ Connector test set -V.A.G 1594 C-

Test conditions

- Oil level OK
- Engine oil temperature approximately 90°C.

Test sequence

- Remove rear engine cover -arrows-.

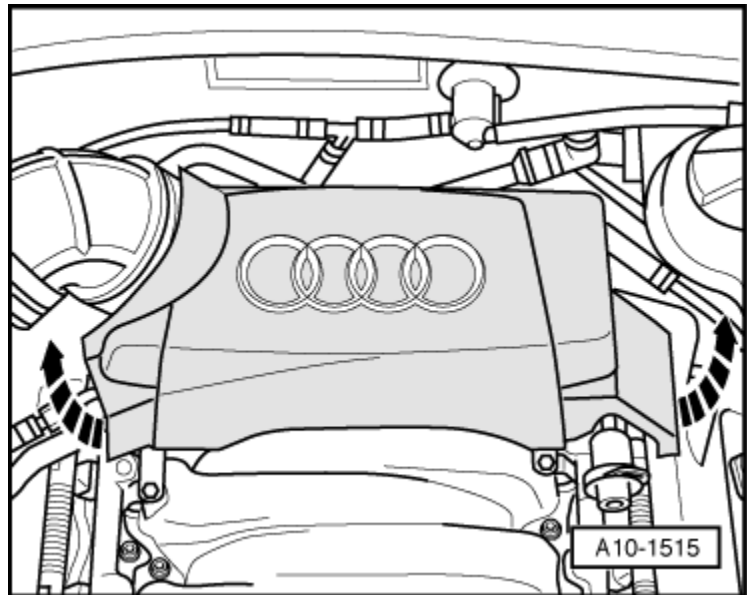

- Disconnect electrical harness connector from oil pressure switch -arrow-.
- Remove oil pressure switch.

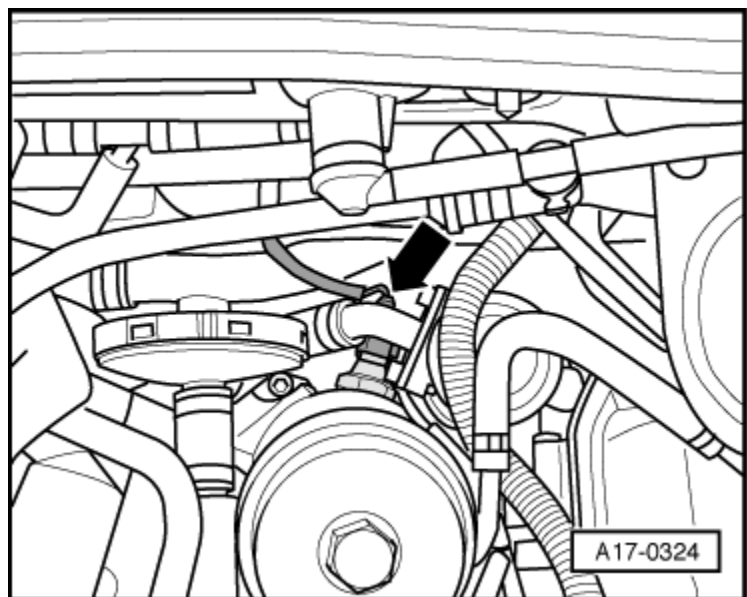

- Connect oil pressure gauge -V.A.G 1342- with adapter -V.A.G 1342/14- to hole for oil pressure switch.
- Thread oil pressure switch -2- into oil pressure tester -V.A.G 1342-.

Oil pressure switch, checking

- Connect brown wire -1- of tester to Ground (GND).
- Connect voltage tester -V.A.G 1527 B- using adapter cables from connector test kit -V.A.G 1594 C- to oil pressure switch and battery plus (“+”).
- LED must not light up
- If LED is lit, oil pressure switch must be

replaced.

- Start engine.

Note

While starting engine, watch Pressure Tester and LED as oil pressure switch may open during start.

- At 1.2 to 1.6 bar pressure, LED must light up.
- If LED is not lit, oil pressure switch must be replaced.

Oil pressure, checking

- Start engine (engine oil temperature approximately 90°C).
- Oil pressure at 2000 RPM: min. 2.0 bar.
- Oil pressure at 3500 RPM: min. 3.5 bar.

Note

Replace sealing ring when installing oil pressure switch.

Torque specifications

Component	Nm
Oil pressure switch to oil filter housing	25

