

Left Engine Mount, Removing and Installing  
Special tools and workshop equipment required

Left Engine support bridge - 10-222 A -

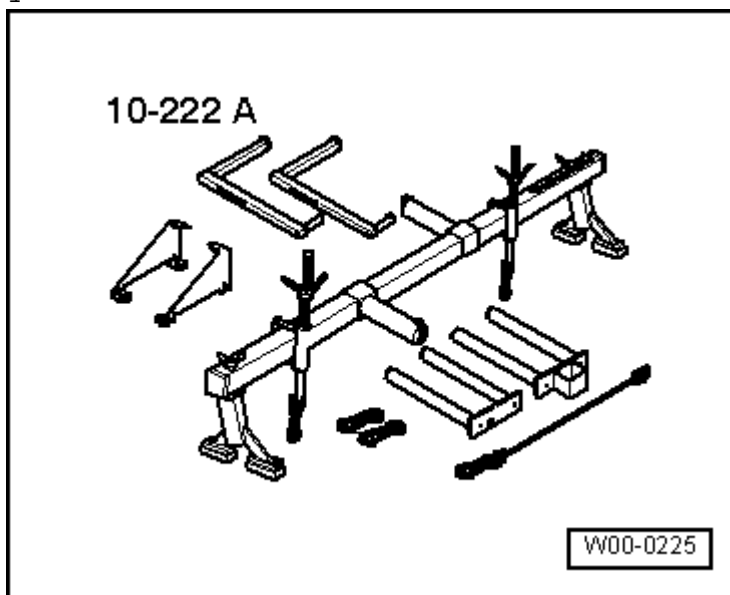

Left Engine Support Basic Set - T40091 -

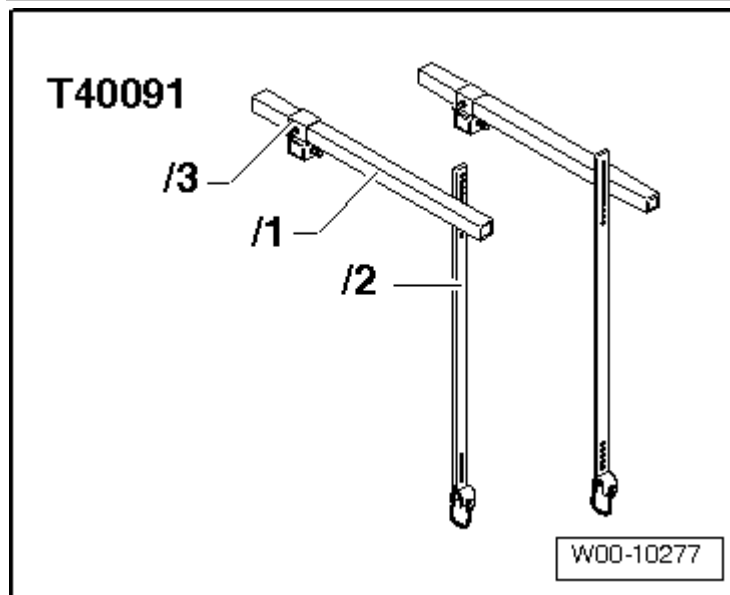

Left Engine Support Supplement Set - T40093 -

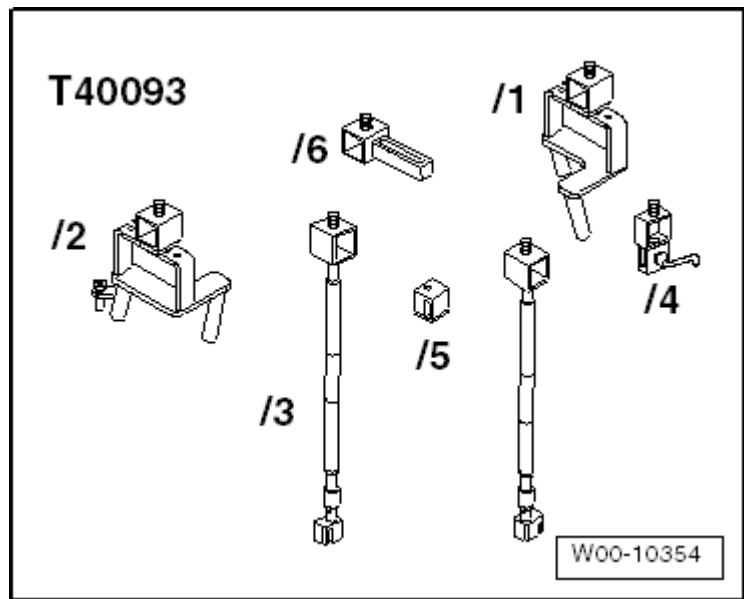

Removing

- Pull rear engine cover off -arrows-.

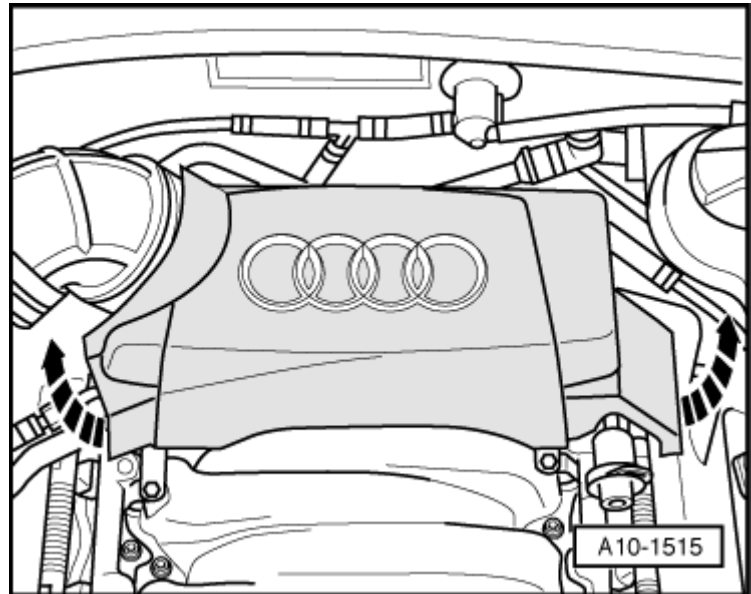

- Remove rubber seal -1- and remove plenum chamber cover -2-.

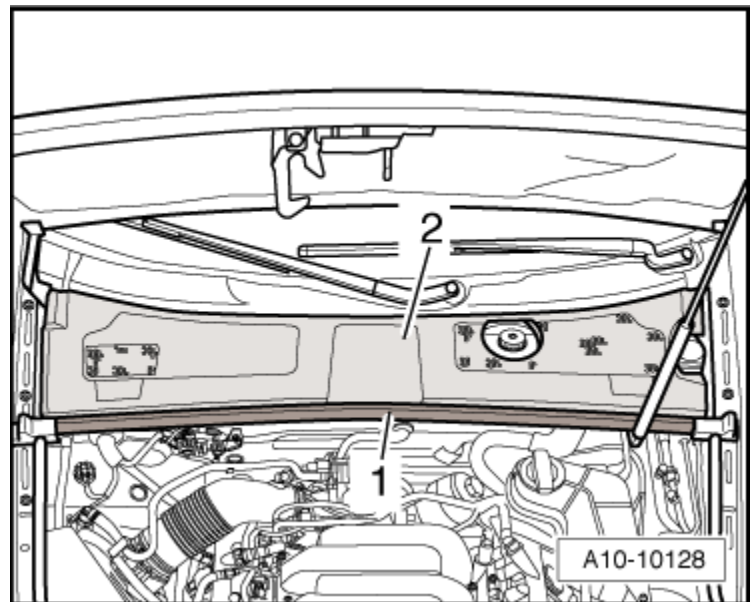

Mount the engine support bridge -10 - 222 A /4- with the engine support basic set - T40091/3- as well as the engine support supplement -T40093/1- and -T40093/2- to the strut towers, as illustrated.

1 Support for left and right side of vehicle is marked.

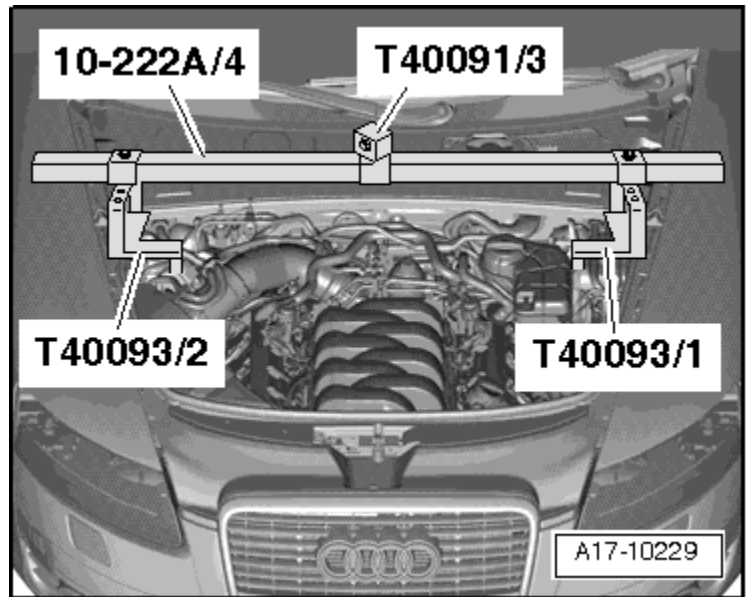

Mount the additional parts from the engine support bridge -10 - 222 A -, -T40091- and -T40093- as illustrated. Position the supports -T40093/3- on the notches on the longitudinal members.

- Engage the hook -10 - 222 A /10- into the left engine lifting eyelet.
- Tension the engine with the spindle.

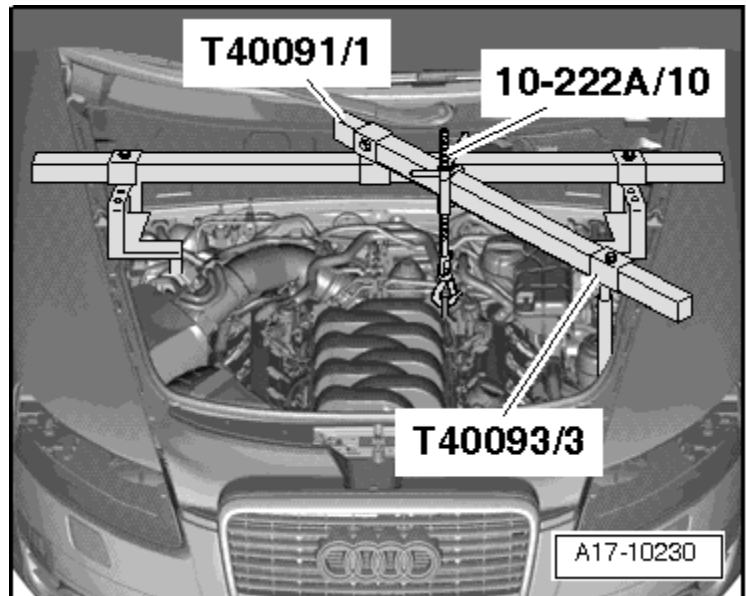

- Remove noise insulation. Refer to [Body Exterior; Rep. Gr.50](#).

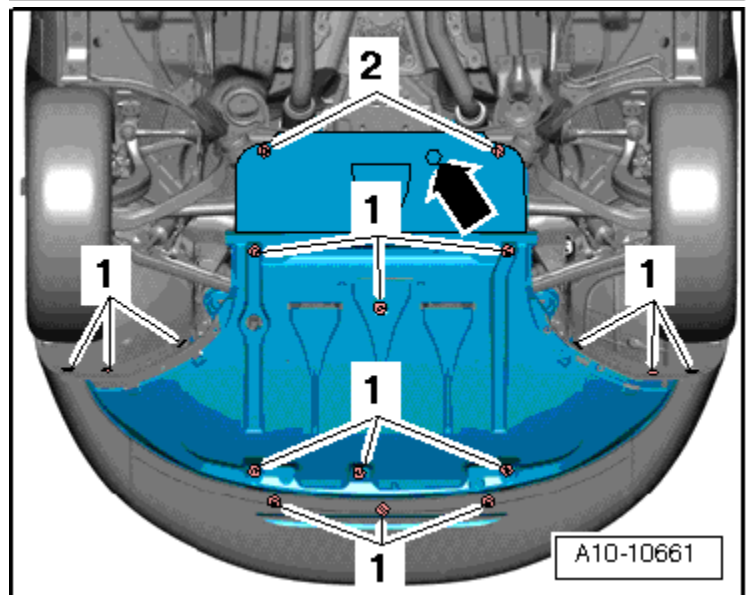

Vehicles with auxiliary heater:

- Remove the left front wheel.
- Remove the left front wheel housing liner. Refer to → [Body Exterior; Rep. Gr.66](#).
- Remove the exhaust pipe bolt - arrow -.

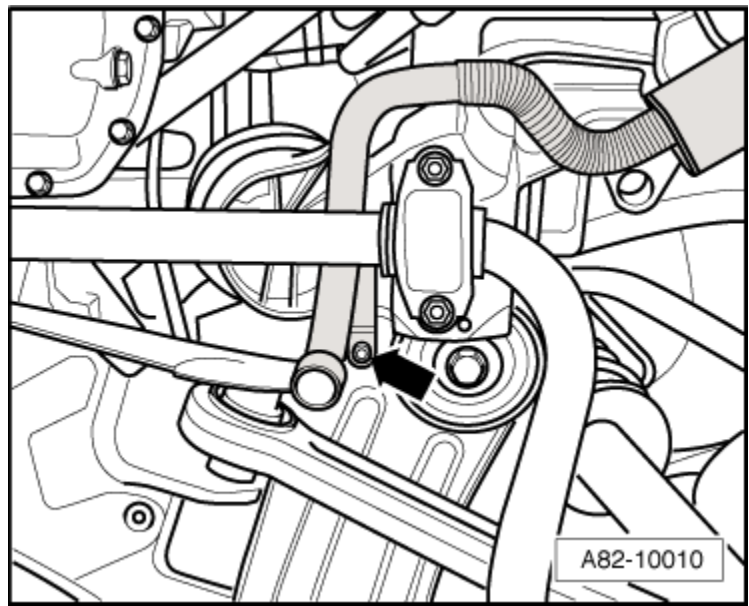

- Loosen the nut -A- on the exhaust pipe clamp.
- Remove the bolt -B- and remove the muffler and the corrugated exhaust pipe.

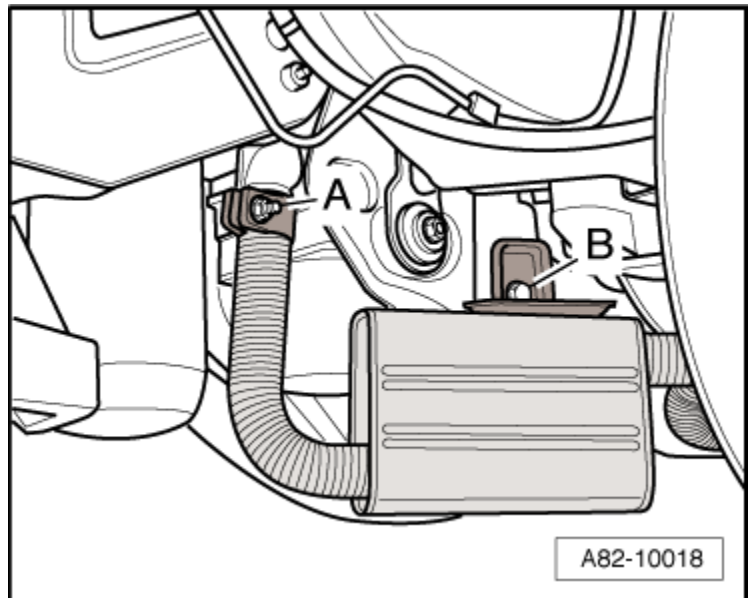

All Vehicles

- Remove the bolts -1- and -2- for the left and right stabilizer mounts and lower the stabilizer bar slightly.

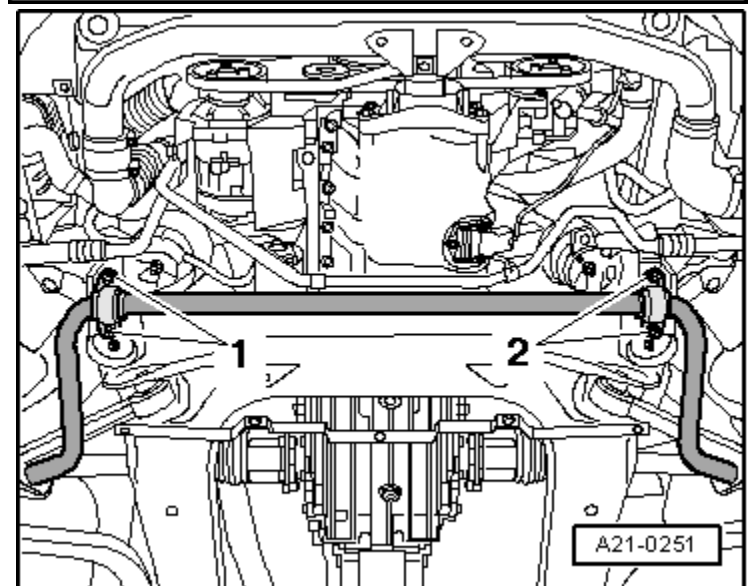

- Remove the nuts -3-.
- Remove the bolts -1- and -2- and remove the left engine mount console.



Note

The illustration shows the right engine mount console instead.

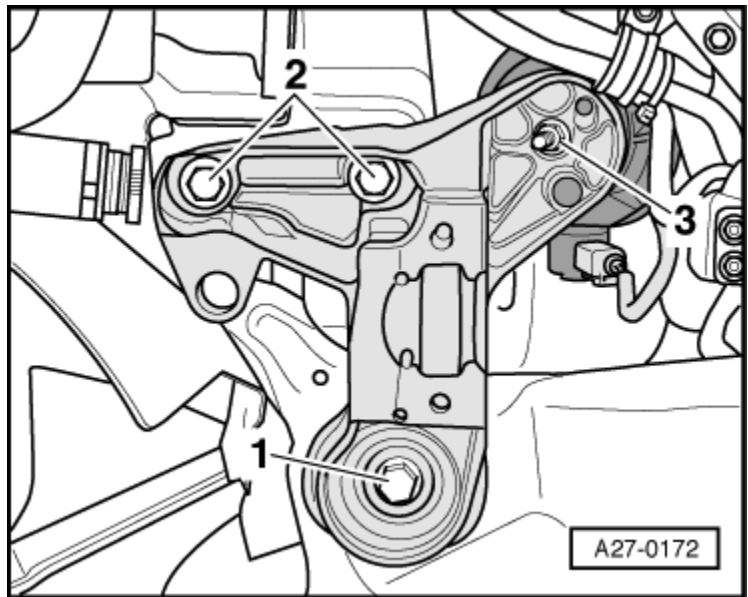

- Disconnect the connector -1- on the left electro-hydraulic engine mount solenoid valve -N144-, if equipped.
- Remove the bolts -arrows- and remove the engine supports with the engine brackets.

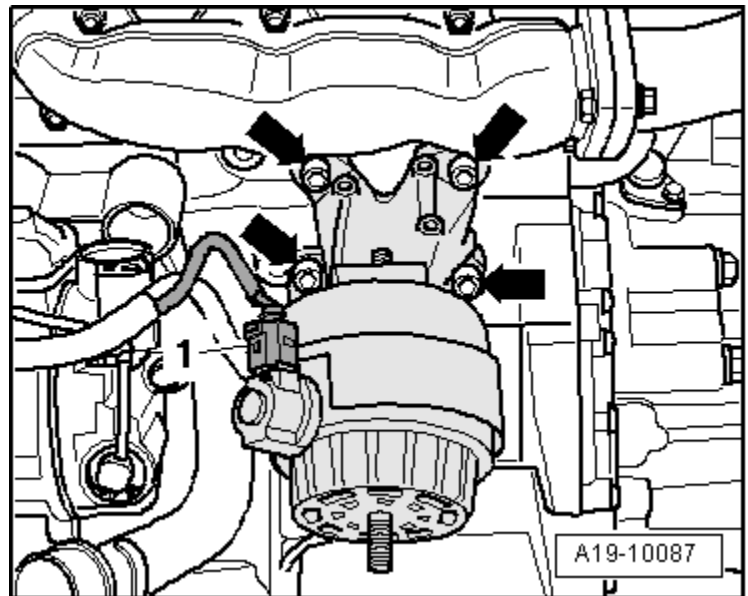

- Remove the nut -arrow- and remove the engine bracket from the engine support.

Installing

1 Tightening specifications → [Chapter](#).

Installation is performed in reverse order of removal, noting the following:



Note

- Replace bolts which have been tightened to torque.
- During installation, all cable ties must be re-installed at the same location.
- Install the subframe and stabilizer bar.
- Refer to → [Suspension, Wheels, Steering; Rep. Gr.40](#).

