

Opening and closing

Keys

Key set

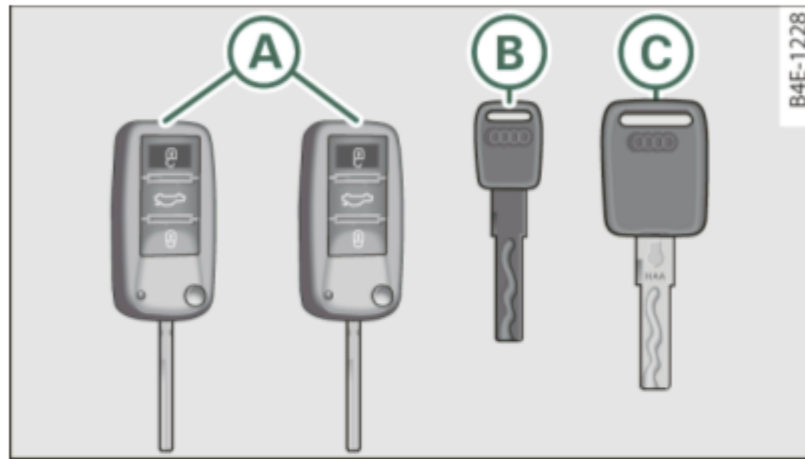

Fig. 30 Key set

(A) Master key with remote control

You can centrally lock and unlock your vehicle and start the engine with the master key with remote control.

(B) Valet key

The valet key fits only the driver's door and the ignition lock. If you have to leave the key with somebody else, you are well-advised to turn over the valet key only.

Be aware that the rear lid can be opened from inside the vehicle with the remote rear lid release located in the driver's door. Before you turn over the valet key you should therefore lock the rear lid mechanically with the master key.

Turn the master key **clockwise** to the **horizontal** position and pull it out. This has two effects:

- the **remote rear lid release is deactivated**,
- the **lid will remain locked** when the power locking system is actuated.

In this state the rear lid can be unlocked only with the remote control unlock button  on the master key.

(C) Emergency key

The emergency key is only for temporary use if the vehicle key should be lost or misplaced ⇒ .

Key replacement

If you lose a key, contact your authorized Audi dealer immediately to have the *lost* key disabled. Be sure to bring all your keys with you.

WARNING

- **Do not leave your vehicle unattended with the key in the ignition lock. Entry by unauthorized persons could endanger you or result in theft or damage the vehicle. Always lock all doors and take the key.**
- **Do not leave children unattended in the vehicle, especially with access to vehicle keys. Unguarded access to the keys provides children the opportunity to start the engine and/or activate vehicle systems such as the power windows etc. Unsupervised operation of any vehicle system by children can result in serious injury.**

Tips

- If you open the driver's door with the key left in the ignition lock, a chime will sound. This is your reminder to remove the key and lock the door.
- For security reasons, replacement keys are only available from Audi dealers. ■