

## Audi 100, S4, A6, S6 > 1992-1998

### 4 Spd. Automatic Transmission 01F All Wheel Drive

### 37 - Selector Lever Mechanism and Controls, Servicing

#### Selector Lever Mechanism, Disassembling and Assembling

The following tasks are necessary for disassembling the selector lever mechanism.

- ▶ For working on selector lever housing, remove shift lock solenoid or front center console locking cable. ⇒ Body Exterior, Interior - Repair Group 70
- ▶ To replace locking cable, also remove steering wheel and instrument cluster. ⇒ Electrical Equipment - Repair Group 90
- ▶ The complete selector lever mechanism is removed upward.

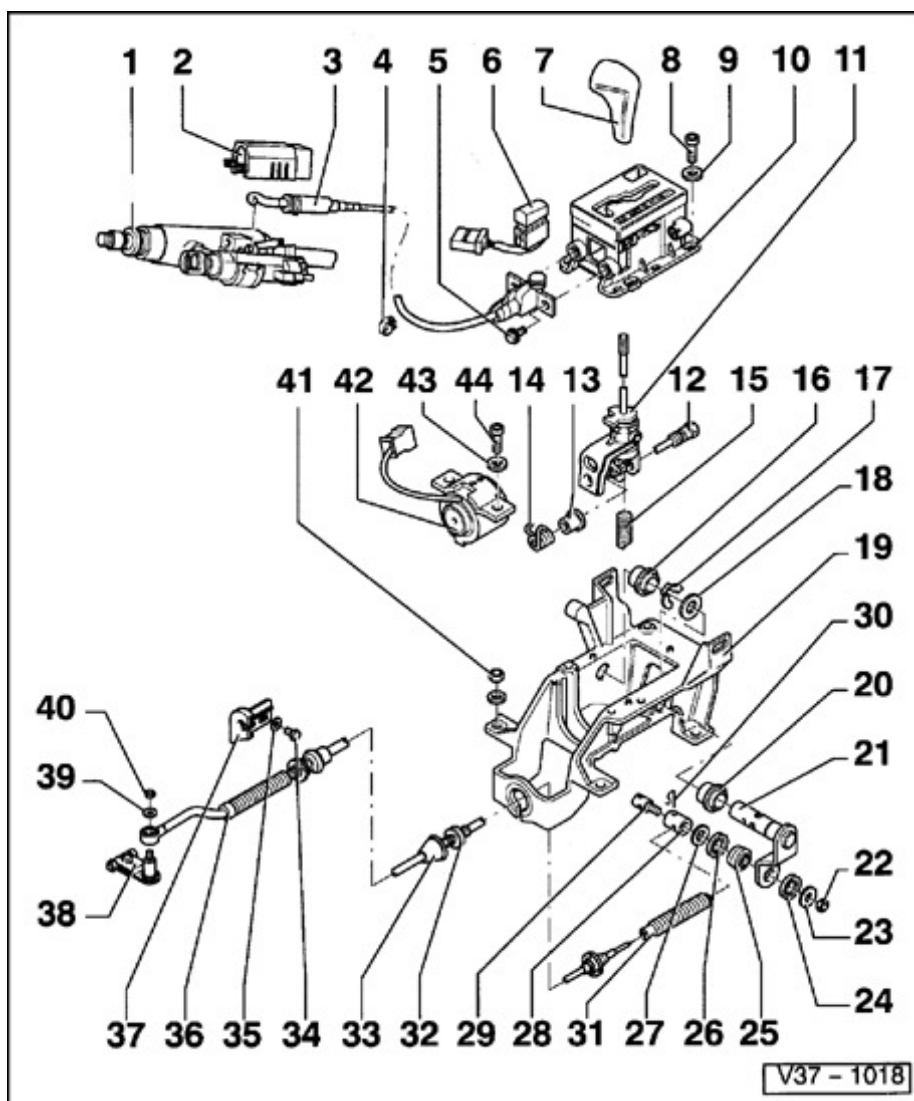

**1 - Ignition switch**

**2 - Trim cover**

**3 - Locking cable**

- ▶ To remove and install center console, remove steering wheel and instrument cluster
- ▶ Removing and installing ⇒ [Locking Cable, Removing, Installing and Adjusting](#)
- ▶ Must not be kinked
- ▶ Adjusting

#### **4 - Cable clip**

- ▶ Installing Locking cable removing, installing and adjusting, ⇒ ⇒ [Locking Cable, Removing, Installing and Adjusting](#)

#### **5 - Bolt**

- ▶ 10 Nm (7 ft lb)

#### **6 - Not installed**

#### **7 - Selector lever handle**

#### **8 - Bolt**

- ▶ 10 Nm (7 ft lb)

#### **9 - Washer**

#### **10 - Selector lever housing**

- ▶ Before removing, disconnect locking cable on selector lever housing
- ▶ Install after adjusting Shift Lock Solenoid N110
- ▶ Aligning

#### **11 - Selector lever**

- ▶ With clevis for locking selector lever in positions "P" and "N" , as well as detent for unlocking ignition key by means of locking cable with selector lever in position "P"
- ▶ Checking clearance between selector lever and Shift Lock Solenoid N110

#### **12 - Guide pin**

- ▶ 22 Nm (16 ft lb)

#### **13 - Bushing**

#### **14 - Torsion spring**

#### **15 - Compression spring**

#### **16 - Bushing**

- ▶ After installing, grease with Grease G 000 660

**17 - Locking plate****18 - Washer****19 - Selector mechanism housing**

- ▶ Place a 18 x 6.1 x 2 mm shim under both front threaded bolts before installing selector mechanism housing

**20 - Bushing**

- ▶ After installing, grease with Grease G 000 660

**21 - Selector mechanism lever****22 - Nut**

- ▶ 20 Nm (15 ft lb)

**23 - Washer****24 - Cup****25 - Bushing****26 - Cup****27 - Washer****28 - Clamping sleeve**

- ▶ For selector lever cable

**29 - Clamping bolt**

- ▶ For selector lever cable

**30 - Spring clip****31 - Rear boot**

- ▶ Replace if damaged
- ▶ Make sure installation position is correct

**32 - Selector lever cable**

- ▶ With guide and bushing
- ▶ Tighten selector lever cable brackets to 12 Nm (9 ft lb)
- ▶ Check guide tube for tight fit
- ▶ Do not bend or kink selector lever cable

- ▶ Grease bearing for selector lever cable on transmission selector lever with Grease G 000 660
- ▶ Make sure boot is correctly installed for selector lever cable, otherwise moisture can penetrate into selector lever cable
- ▶ Adjusting ⇒ [Selector Lever Cable, Adjusting](#)

### **33 - Grommet**

- ▶ Replace if damaged
- ▶ Make sure installation position is correct

### **34 - Bolt**

- ▶ 23 Nm (17 ft lb)

### **35 - Washer**

### **36 - Front boot**

- ▶ Replace selector lever cable if damaged

### **37 - Bracket**

- ▶ For selector lever cable
- ▶ On transmission

### **38 - Transmission selector lever**

- ▶ Grease bearing for selector lever cable with Grease G 000 660

### **39 - Washer**

- ▶ Installed with tab toward selector lever cable
- ▶ Grease tab with Grease G 000 660

### **40 - Nut**

- ▶ 8 Nm (71 in. lb)

### **41 - Flanged nut**

- ▶ 10 Nm (7 ft lb)

### **42 - Shift Lock Solenoid N110**

- ▶ Testing using On Board Diagnostic (OBD) ⇒ Automatic Transmission On Board Diagnostic - Repair Group 01

Installing:

- Press solenoid with detent in axial direction against selector mechanism housing and tighten solenoid screws.
- After installing selector mechanism, switch ignition on. Solenoid blocks selector lever in positions "P" and "N." With brake pedal depressed, selector lever can be moved out of positions "P" or "N" .
- ▶ Checking clearance between selector lever and solenoid

#### 43 - Washer

#### 44 - Screw

- ▶ 10 Nm (7 ft lb)

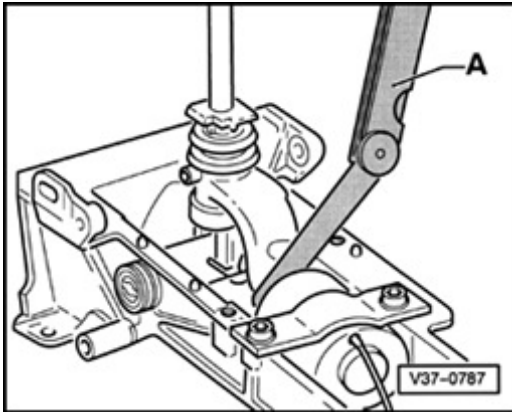

**Fig. 1 Checking clearance between selector lever and Shift Lock Solenoid N110**

- In selector lever position "R" , check gap between selector lever and shift lock solenoid using feeler gauge - **A** - .
- ▶ Specified value: 0.6-1.4 mm.
- If necessary, adjust gap by sliding solenoid in mounting holes.

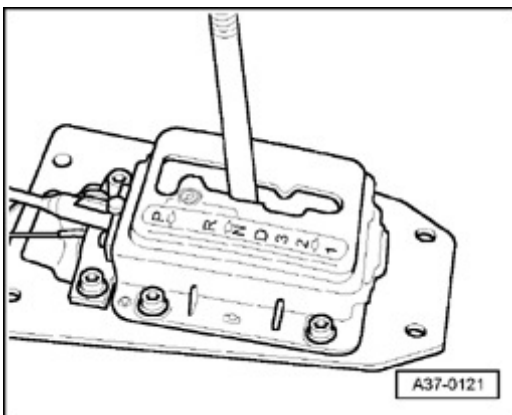

**Fig. 2 Aligning selector lever housing to selector lever**

- After installing shift lock solenoid, place lower hole of clevis on center of solenoid and apply voltage to solenoid.
- Install selector lever housing. Selector lever must be opposite position "N" on housing.

- After tightening selector lever housing, move selector lever through all positions and check if stop is reached at position "P" and position "1."

*Copyright © 2006 Audi of America, Inc. and Bentley Publishers. All rights reserved. Last processed:*