

Audi > C4 > 1992 - 1998**4 Spd. Automatic Transmission 01K Front Wheel Drive****39 - Final drive, Differential****Front final drive, servicing****Notes:**

- ▶ The components shown in the following illustration can be removed with the transmission installed.
- ▶ Rules of cleanliness for working on automatic transmissions => Page [37-57](#).
- ▶ General repair instructions => Page [00-7](#).
- ▶ Coat O-rings and seals with a thin coat of Vaseline (petroleum jelly). Other lubricants lead to malfunctions in the hydraulic transmission control.
- ▶ Do not interchange the outer or inner races on the same size bearings

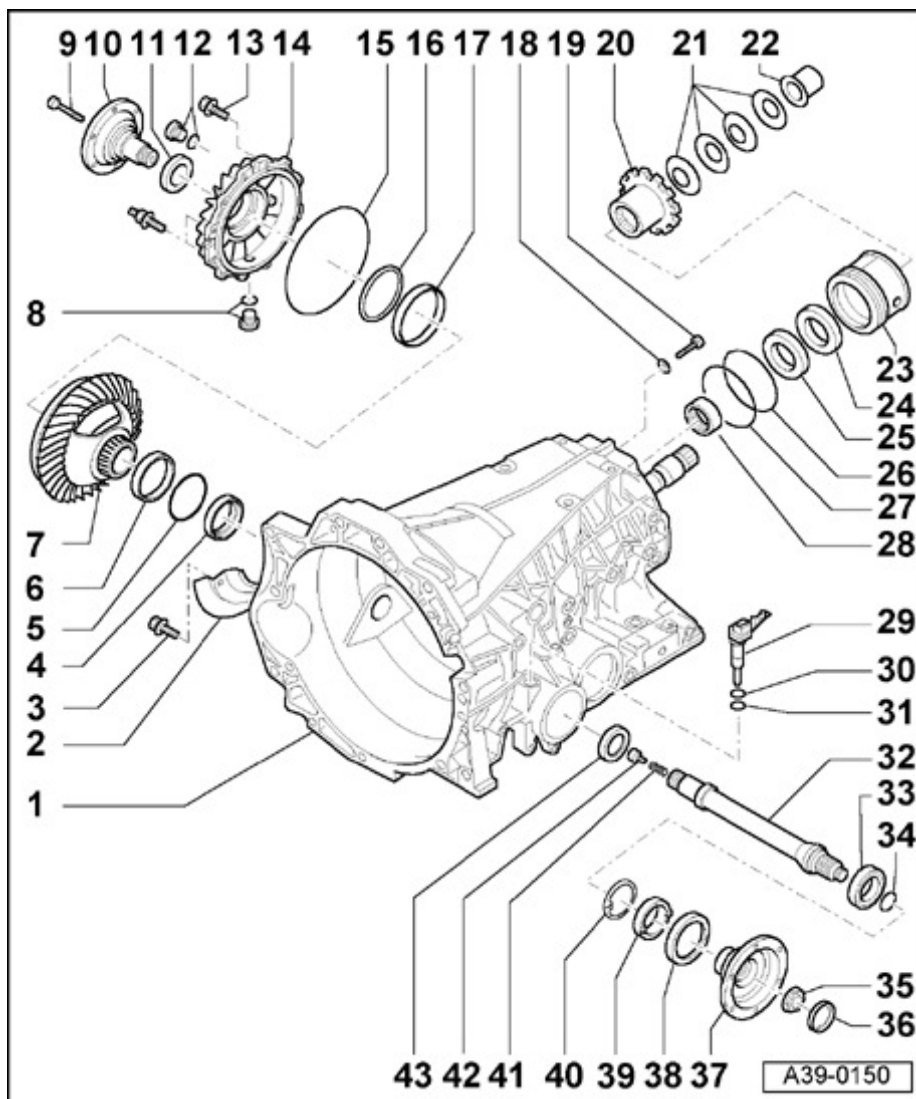

1 -Transmission housing

2 -Sound baffle

3 -Bolts

- ◆ 8 Nm (71 in. lb)
- ◆ Qty.: 2

4 -Drive axle seal, right

- ◆ Replacing => Page [39-17](#)

5 -Shim

- ◆ Location: behind bearing race
- ◆ Size is preset, do not replace with shim of different size

6 -Bearing outer race

- ◆ Remove and install manually

7 -Differential gear

- ◆ With tapered roller bearing
- ◆ With impulse wheel for transmission Vehicle Speed Sensor (VSS) -G38-

8 -Oil drain plug

- ◆ 50 Nm (37 ft lb)
- ◆ With seal

9 -Center bolt

- ◆ 25 Nm (18 ft lb)

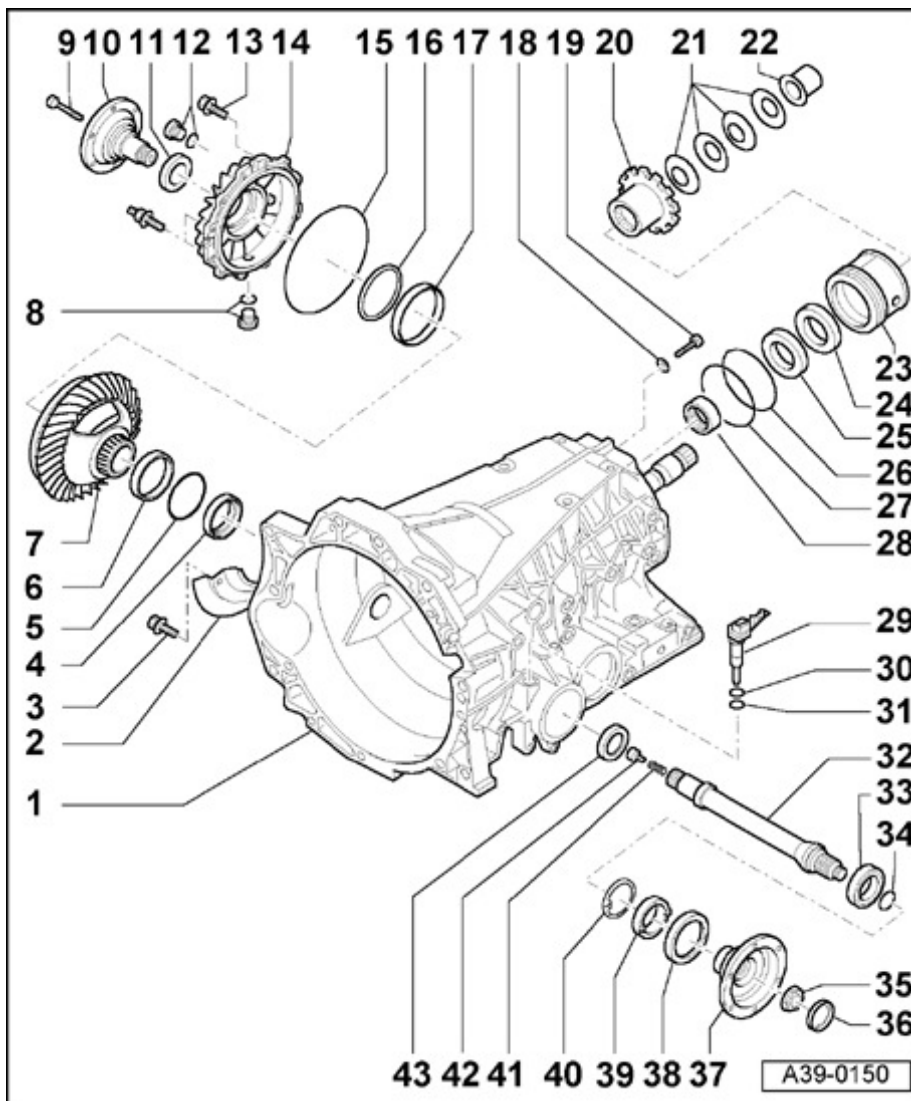

10 -Drive flange, right

- ◆ Removing and installing => Page [39-14](#)

11 -Drive flange seal, right

- ◆ Replacing => Page [39-14](#)

12 -Oil filler plug

- ◆ 50 Nm (37 ft lb)
- ◆ For checking gear oil level
- ◆ With seal

13 -Bolts

- ◆ 23 Nm (17 ft lb)
- ◆ Qty.: 12
- ◆ For mounting front final drive cover -[14](#)-

14 -Front final drive cover

- ◆ With Transmission Vehicle Speed Sensor (VSS) -G38-
- ◆ Transmission Vehicle Speed Sensor (VSS) -G38-, removing and installing Fig. 1

15 -O-ring

- ◆ Replacing => Page [39-17](#)
- ◆ Coat with Vaseline when installing

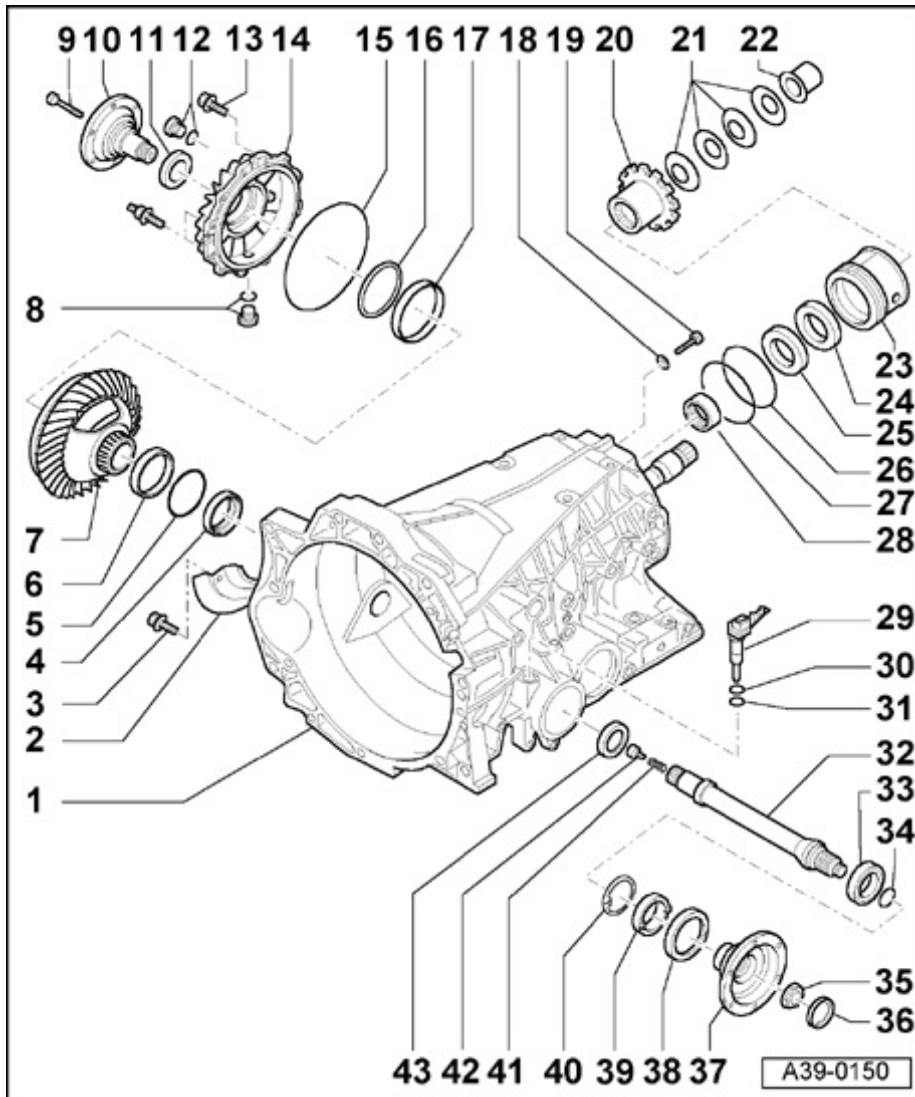

16 -Shim

- ◆ Location: behind bearing race
- ◆ Size is preset, do not replace with shim of different size

17 -Bearing outer race

18 -Washer

19 -Bolt

- ◆ 23 Nm (17 ft lb)
- ◆ To secure intermediate bushing -[23](#)-

20 -Parking lock gear**21 -Cup springs**

- ◆ Qty.: 4
- ◆ Always install 2 cup springs against each other

22 -Bushing**23 -Intermediate bushing**

- ◆ Replacing => Page [39-29](#)

24 -Seal

- ◆ For ATF area
- ◆ Pressed into intermediate bushing -[23](#)-
- ◆ Replace only together with intermediate bushing -[23](#)- => Page [39-29](#)

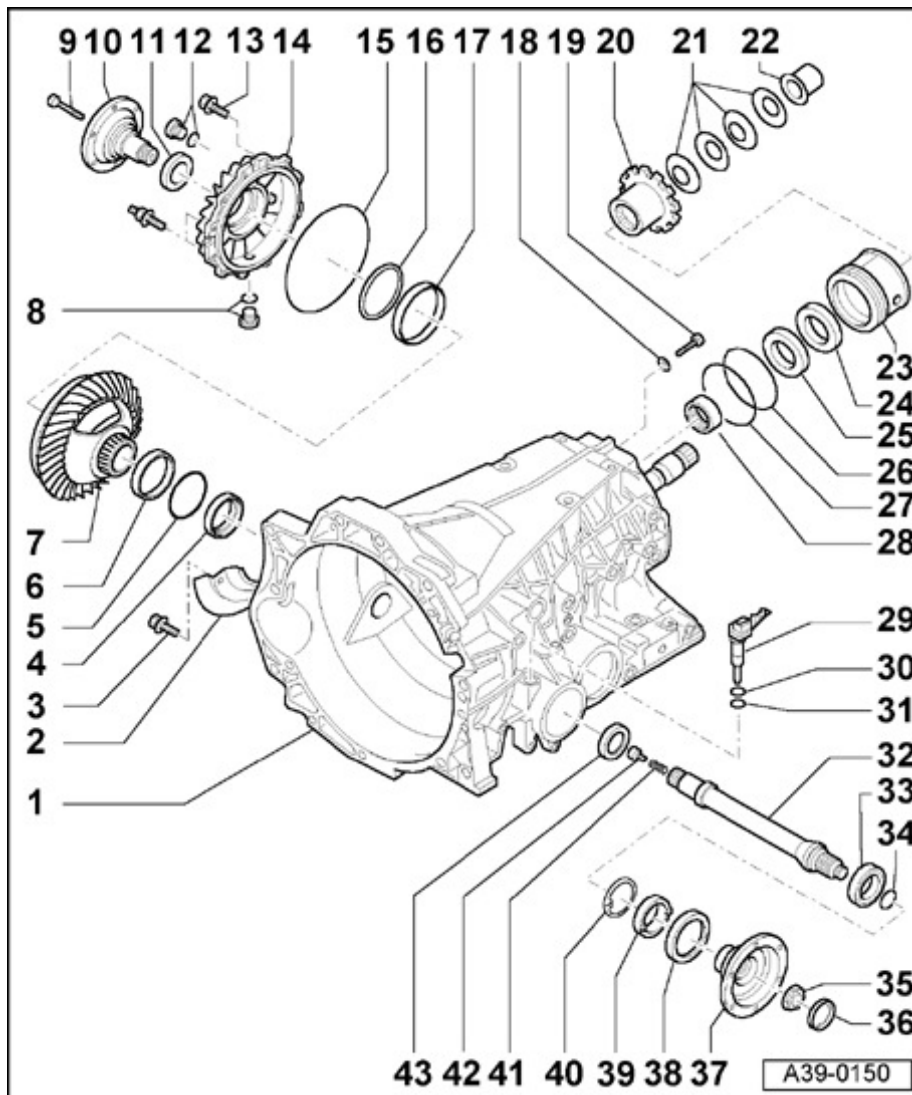
**25 -Seal**

- ◆ For gear oil area

- ◆ Pressed into intermediate bushing -[23](#)-
- ◆ Replace only together with intermediate bushing -[23](#)- => Page [39-29](#)

26 -O-ring

- ◆ Black
- ◆ Replace only together with intermediate bushing -[23](#)- => Page [39-29](#)
- ◆ Coat with Vaseline when installing

27 -O-ring

- ◆ Green
- ◆ Replace only together with intermediate bushing -[23](#)- => Page [39-29](#)
- ◆ Coat with Vaseline when installing

28 -Special nut

- ◆ 120 Nm (98 ft lb)
- ◆ For pinion shaft
- ◆ Replacing => Page [39-29](#)
- ◆ Check for scoring on seals -24- and -25-
- ◆ Crimp at 2 points after installing

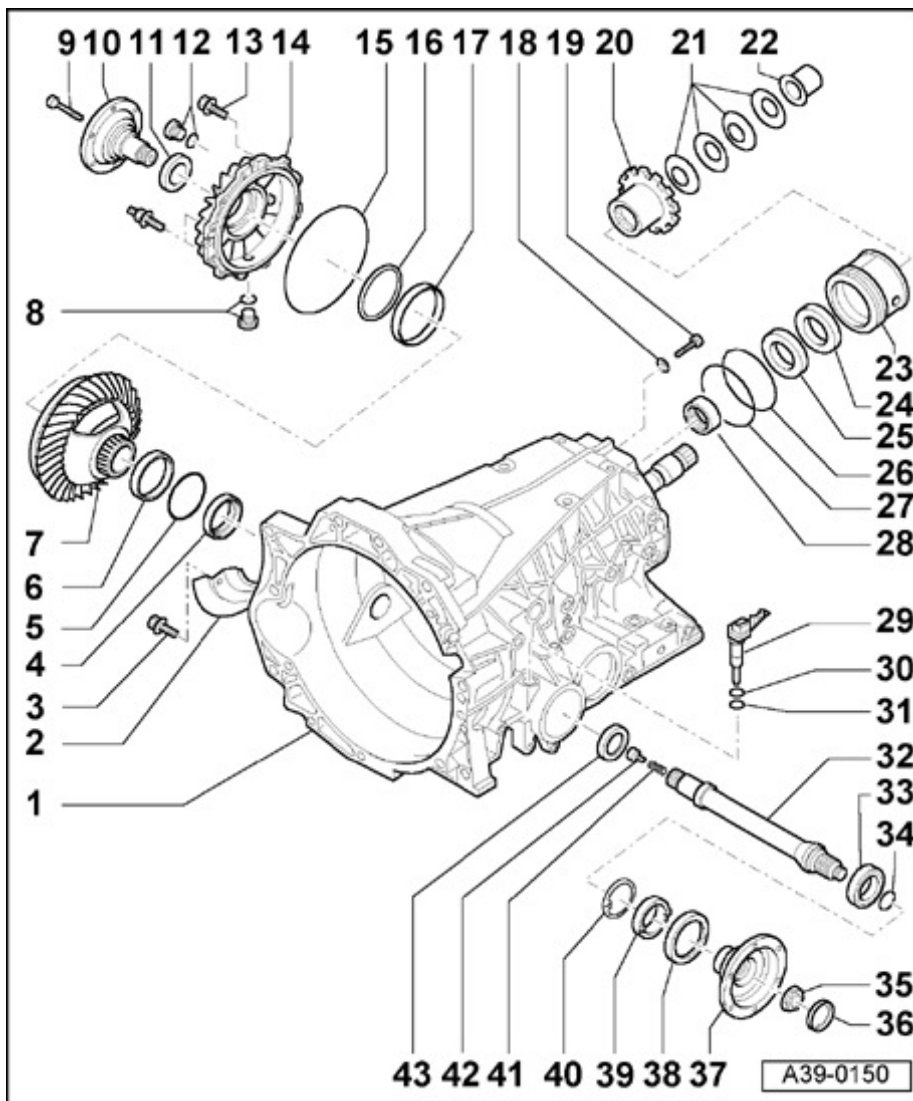

29 -Speedometer Vehicle Speed Sensor (VSS) -G22-

- ◆ Removing and installing => Page [39-1](#)

30 -O-ring

- ◆ Coat with Vaseline when installing

31 -O-ring

- ◆ Coat with Vaseline when installing

32 -Drive axle

- ◆ Removing and installing => Page [39-22](#)

33 -Bearing

- ◆ Install filled with multi-purpose grease

34 -O-ring

35 -Flanged nut

- ◆ 100 Nm (74 ft lb)

- ◆ Securing Fig. 2

36 -Locking plate

- ◆ For flanged nut -35-
- ◆ Replacing => Page [39-22](#)

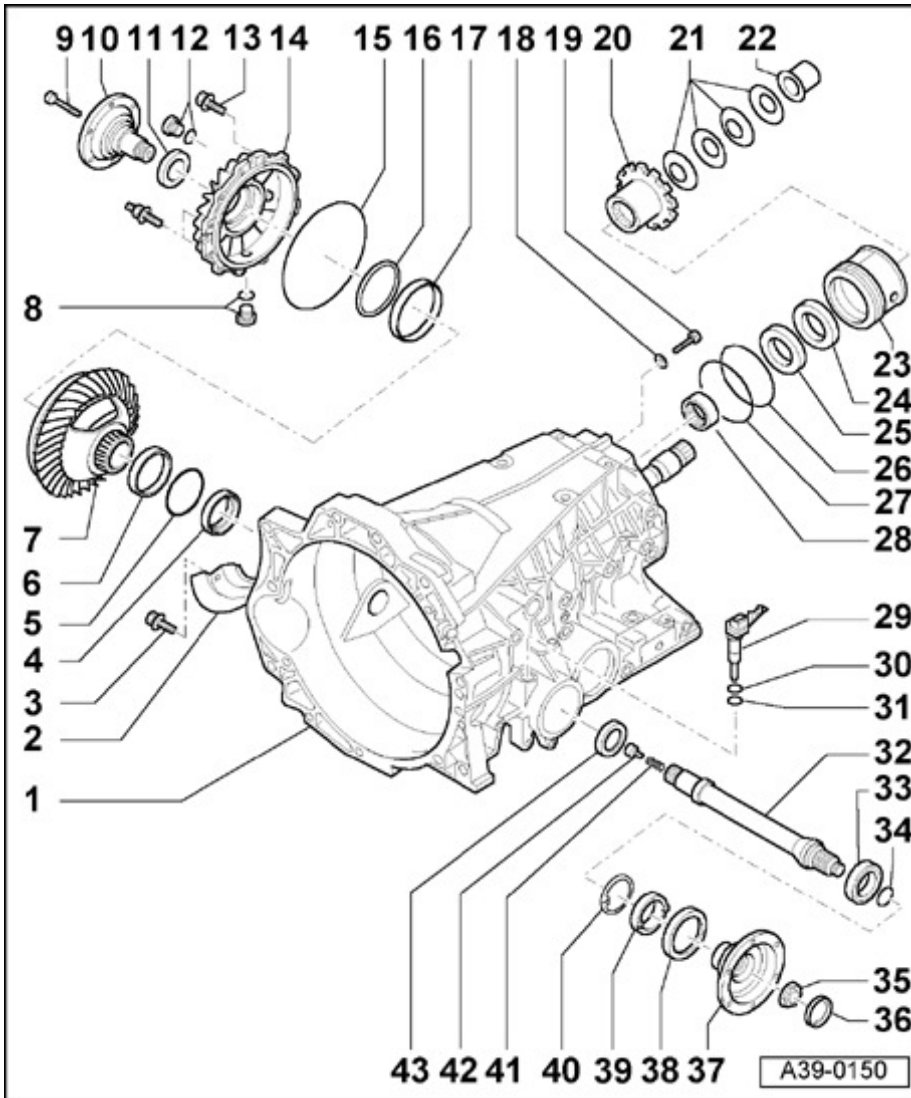

37 -Drive flange, left

- ◆ Removing and installing => Page [39-22](#)

38 -Drive flange seal, left

- ◆ Replacing => Page [39-22](#)

39 -Impulse wheel

- ◆ For speedometer Vehicle Speed Sensor (VSS) -G22-
- ◆ Removing and installing => Page [39-2](#)

40 -Circlip

- ◆ For bearing -33- in transmission housing

41 -Not installed

42 -Not installed

43 -Drive axle seal, left

◆ Replacing => Page [39-22](#)

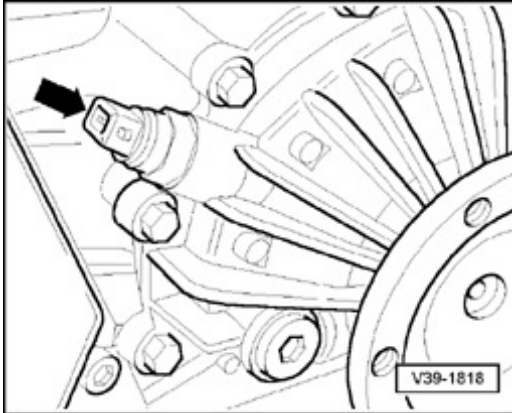

Fig. 1 Removing and installing transmission Vehicle Speed Sensor (VSS) -G38-

Removing

Note:

The transmission is shown removed in the illustration.

- Disconnect harness connector.
- Loosen sensor (arrow) and turn to remove.

Installing

- Replace O-Rings.
- Install sensor with multi-purpose grease and tighten to 30 Nm (22 ft lb).

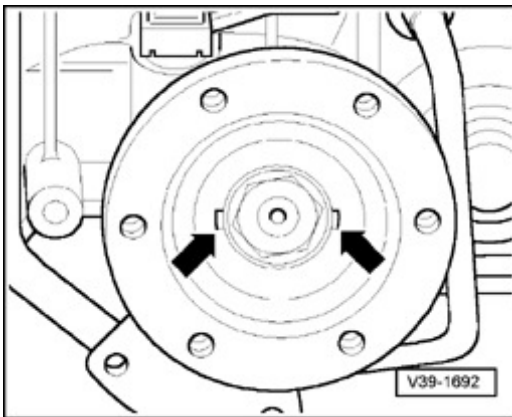

Fig. 2 Securing flanged nut for drive flange

- Secure drive flange with flanged nut and secure with new locking plate (arrows).