

Front Brake Pads, FBC-60, Removing and Installing



Note

Always replace on both axles.

Special tools and workshop equipment required

t Torque Wrench 5–50 Nm -V.A.G 1331-

t Reversible Ratchet -V.A.G. 1331/1-

t Piston Resetting Tool -T10145-

Removing



WARNING

The 4 retaining pins for the brake pads on the brake carrier must not be loosened under any circumstances.

- Raise the vehicle.
- Remove the wheels.



Note

When removing, mark brake pads that will be used again. Install in the same position, otherwise braking effect will be uneven!

- Free up the brake hose on the bracket -4-.

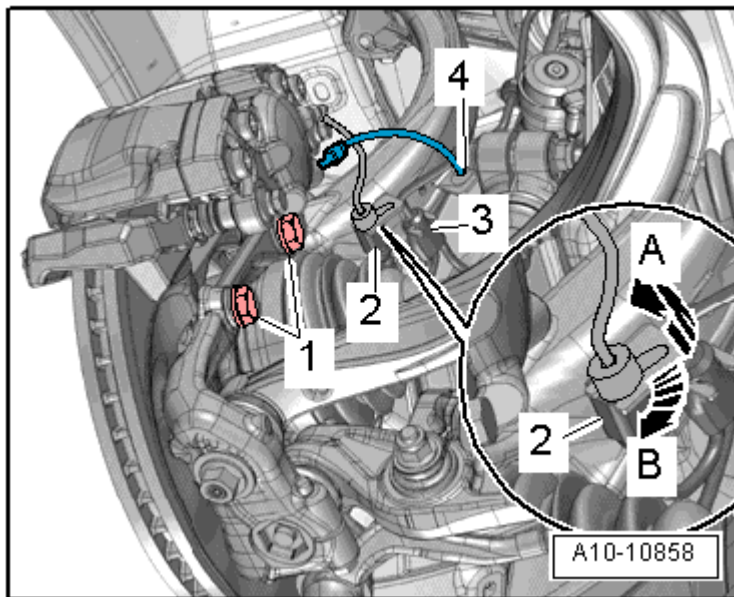

- Release the electrical wire from the bracket -2- toward the left -A- and remove.



WARNING

The four retaining pins for the brake pads in the brake caliper must not be loosened under any circumstances.

- Press the retaining spring -8- in the center.

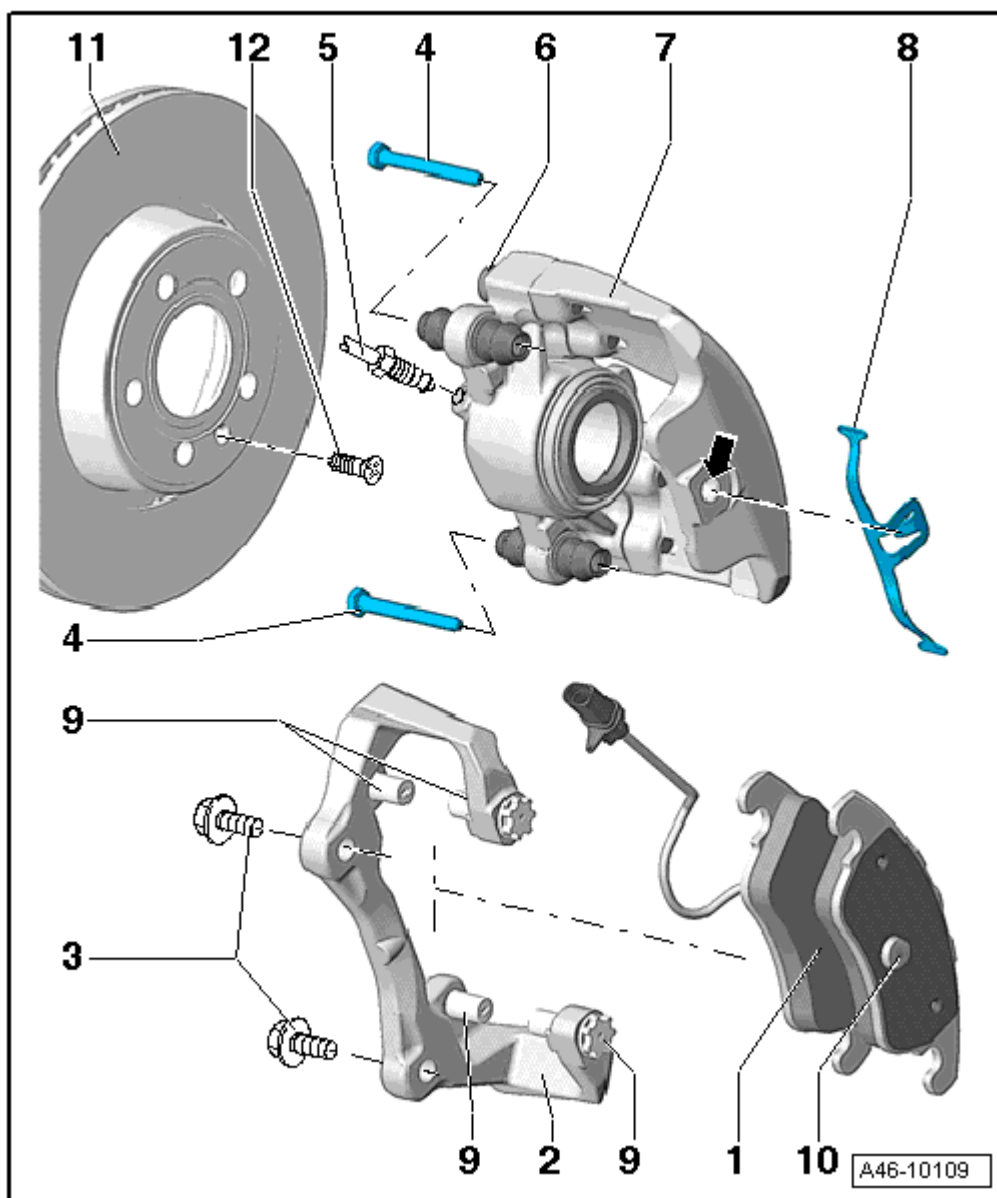

Note

t The spring is tensioned, keep hands protected.

t When removing the spring, make sure it does not scratch the brake caliper or damage the paint.

- Remove the retaining spring carefully.
- Disconnect the left front brake pad wear indicator connector.



Note

Only the inner brake pad in the left front brake caliper has a brake pad wear indicator.

- Loosen and remove both guide pin bolts -4- from the brake caliper.

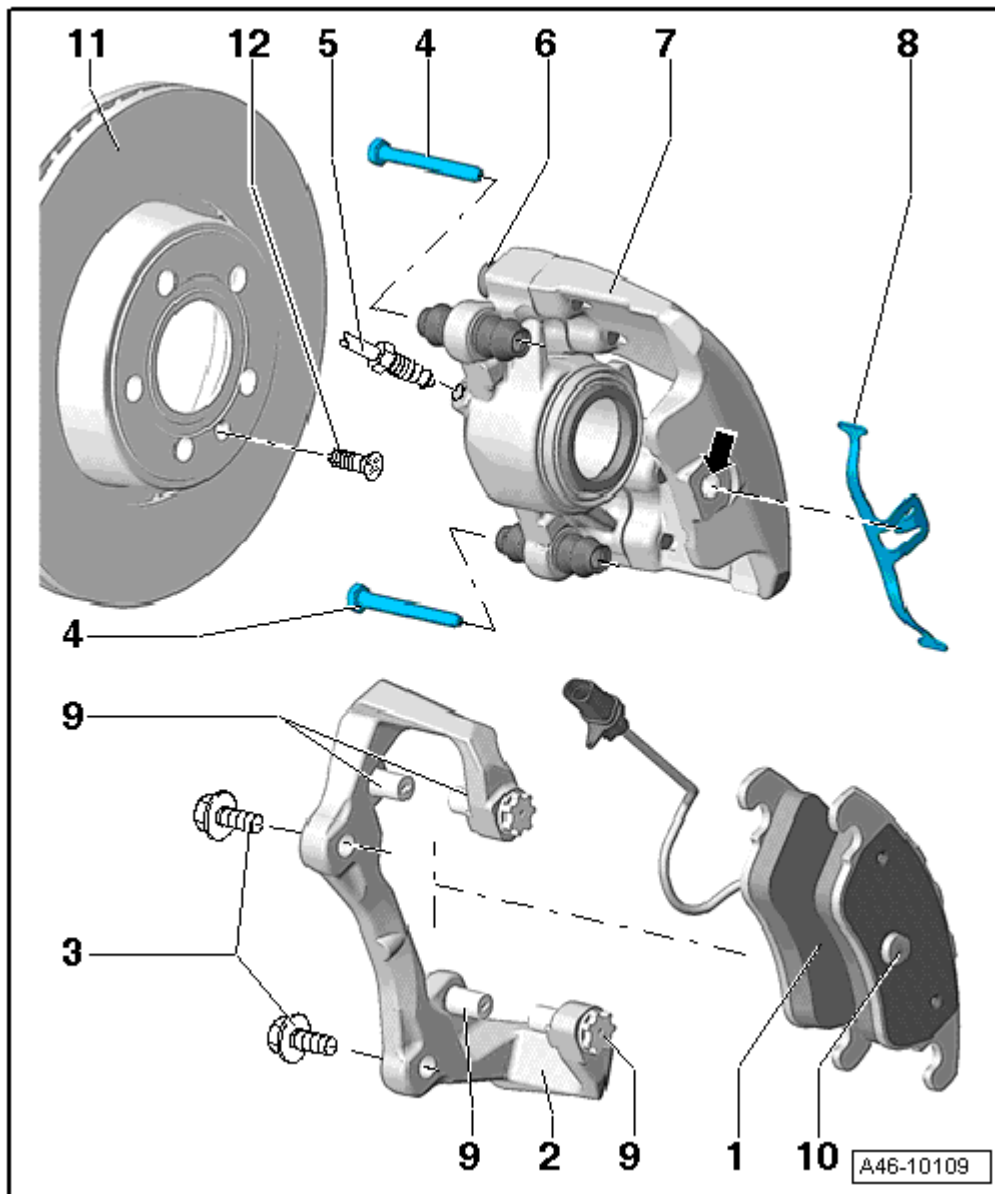
**Caution**

Never remove bolts -6 and 9-

- Pull both guide pins out of the brake caliper slightly to make it easier to remove the caliper.
- Remove the brake caliper.

**Note**

Do not let the brake caliper hang from the brake hose. Secure it to the body with suitable cable ties or wire. Do not support the weight with the brake hose.

- Remove brake pads from brake caliper housing or from brake carrier.

**WARNING**

The four retaining pins for the brake pads in the brake caliper must not be loosened under any circumstances.

Installing

- Clean brake caliper.



Note

t Clean brake caliper with mineral spirits exclusively.

Before inserting new brake pads, press the piston back into the cylinder using the piston resetting tool. Before pushing back the piston, siphon some of the brake fluid out of the brake fluid reservoir. Otherwise, especially if reservoir has been topped off, fluid will overflow and cause damage.



WARNING

Brake fluid is poisonous. NEVER siphon brake fluid with your mouth!

- Press piston back using the T10145.
- Remove any protective film from the brake pad backing plate.

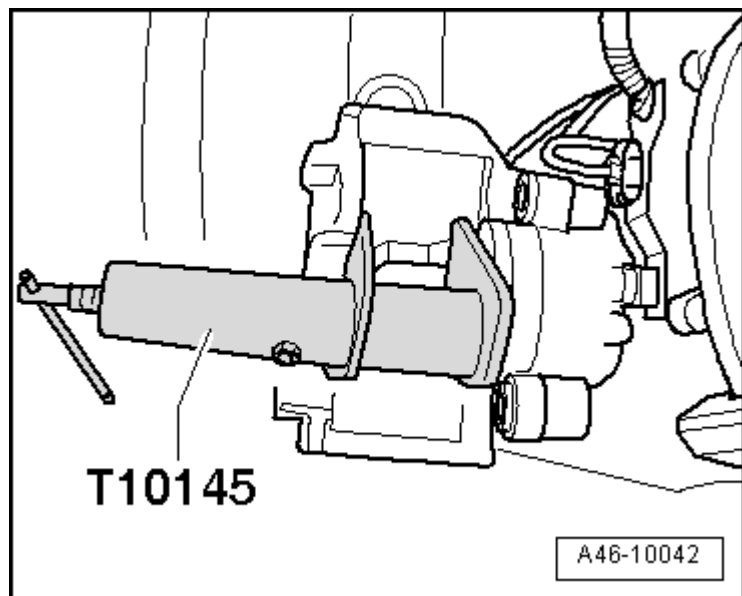

- Insert the inner brake pad with the retaining springs in the brake caliper. The retaining spring -arrow- must sit in the brake piston.
- Insert the inner brake pad with the retaining springs in the brake caliper. The retaining spring -arrow- must sit in the brake piston.

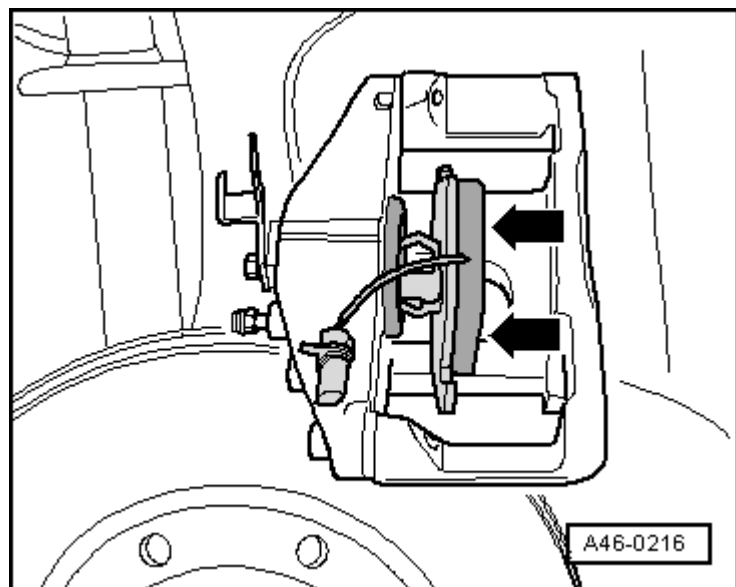

- Insert the outer brake pad -2- into the brake caliper.
- Press the brake pad and mount into the hole in the brake caliper.

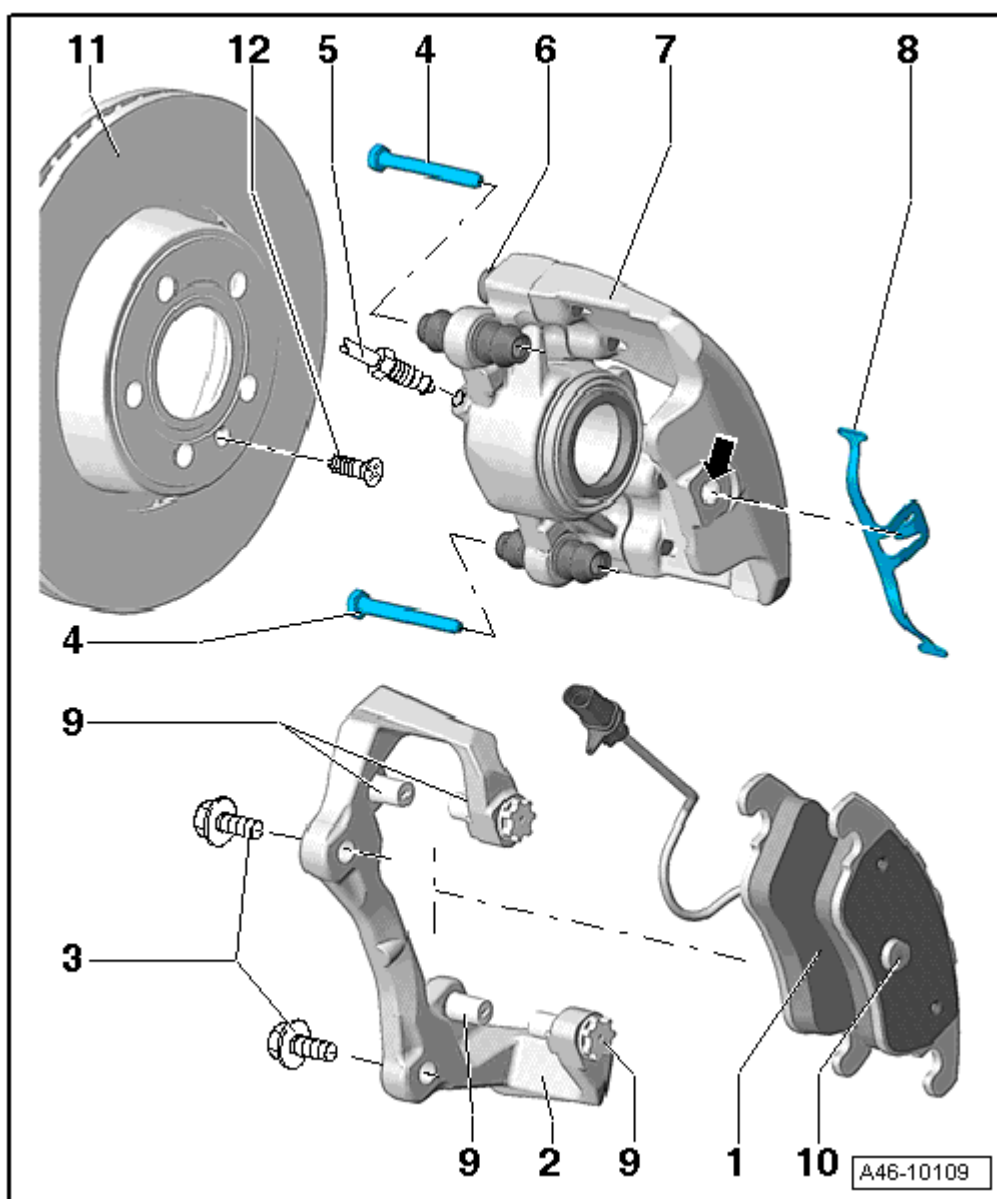
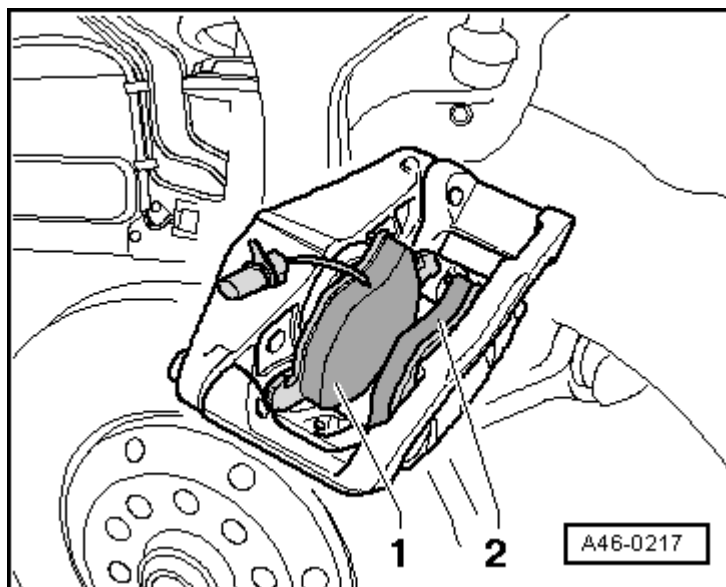

Note

The brake pad has a mount -10- on the backing plate that must sit firmly in the brake caliper hole.

**WARNING**

Both brake pads must sit under the retaining pins in the brake caliper. The brake caliper has two retaining pins at both left and right that must not be loosened.

- Carefully slide the brake caliper with brake pads over the brake disc.
- Tighten the brake caliper on the brake carrier with both guide pins -4-.

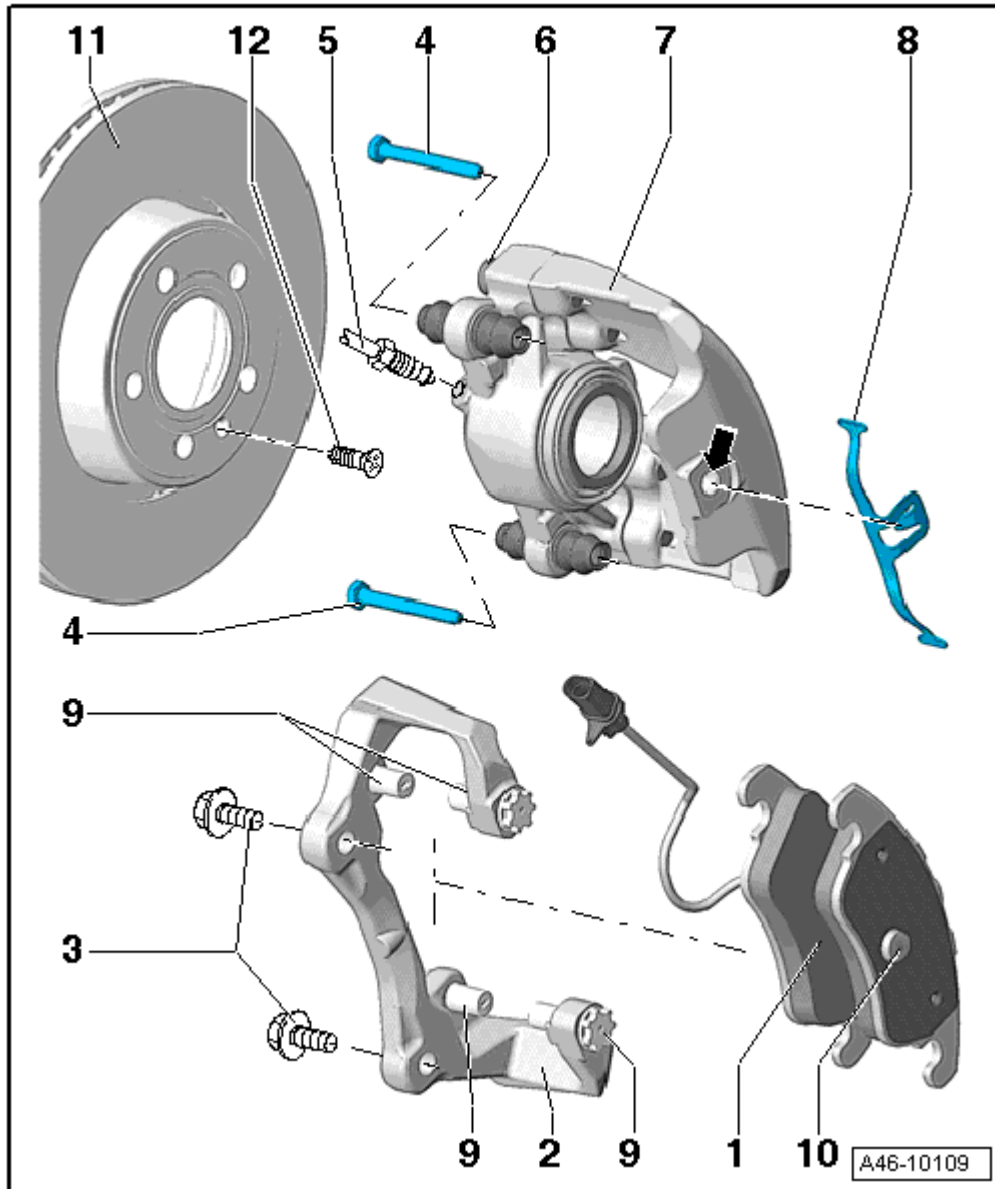

- Position the retaining spring -8- on the outer brake pad.

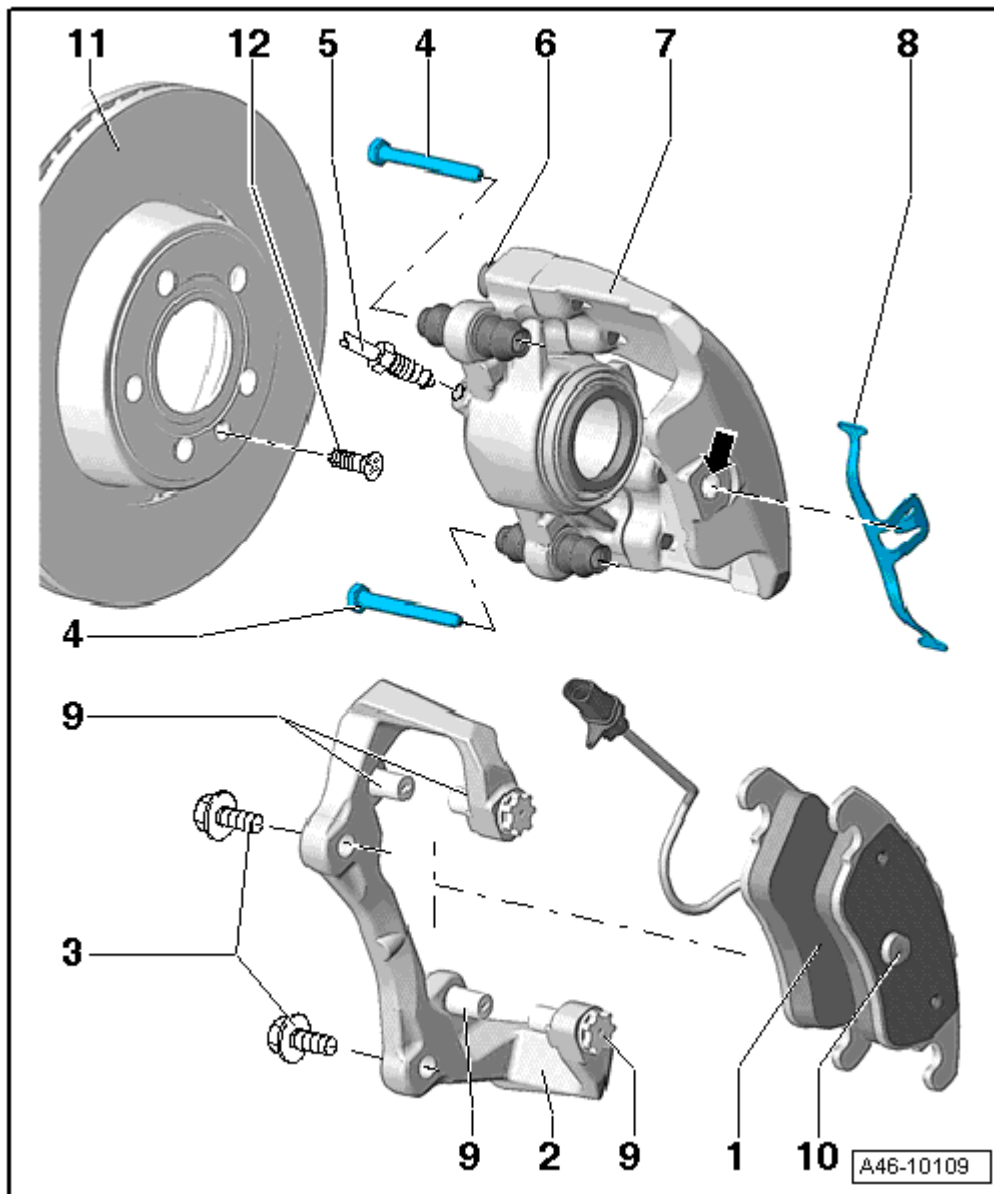

- Press the retaining spring -8- in the center and insert the center tab of the retaining spring in the hole -arrow- on the brake caliper.



Note

- t The retaining spring tab must sit correctly in the hole in the brake caliper or it can spring out and the brake pad will not be held in place.
- t The spring is tensioned, keep hands protected.
- t When removing the spring, make sure it does not scratch the brake caliper or damage the paint.
- Insert the left front brake pad wear indicator connector in the bracket.
- Insert the electrical wire in the bracket -2- and engage it to the right -B-.
- Insert the brake hose in the bracket -4-.

- Connect the left front brake pad wear indicator connector.
- Install the wheels, refer to [→Wheel and Tire Guide; Rep. Gr.44.](#)

**Note**

After installing brake pads, depress brake pedal several times firmly to properly seat brake pads in their normal operating position.

- Check brake fluid level, and fill if necessary.

