

Account

Vehicle

Help

Search

Contact

AutoZone Community

Exit

Your Vehicle: 2010 Audi Q7 Quattro (4LB) V6-3.0L DSL Turbo (CATA)

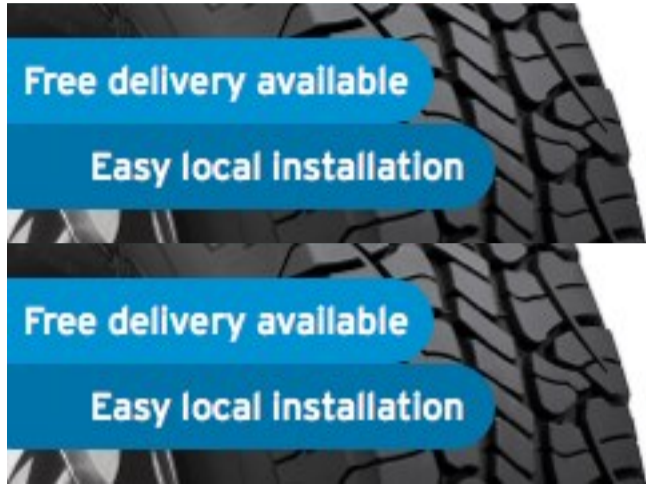

SAVE \$25
instantly on 4 tires!

tirebuyer.com

SAVE NOW >

SAVE \$25
instantly on 4 tires!

tirebuyer.com

SAVE NOW >

[Vehicle](#) » [Body and Frame](#) » [Doors, Hood and Trunk](#) » [Trunk / Liftgate Motor](#) » [Service and Repair](#)

Service and Repair

Lid Drive Unit

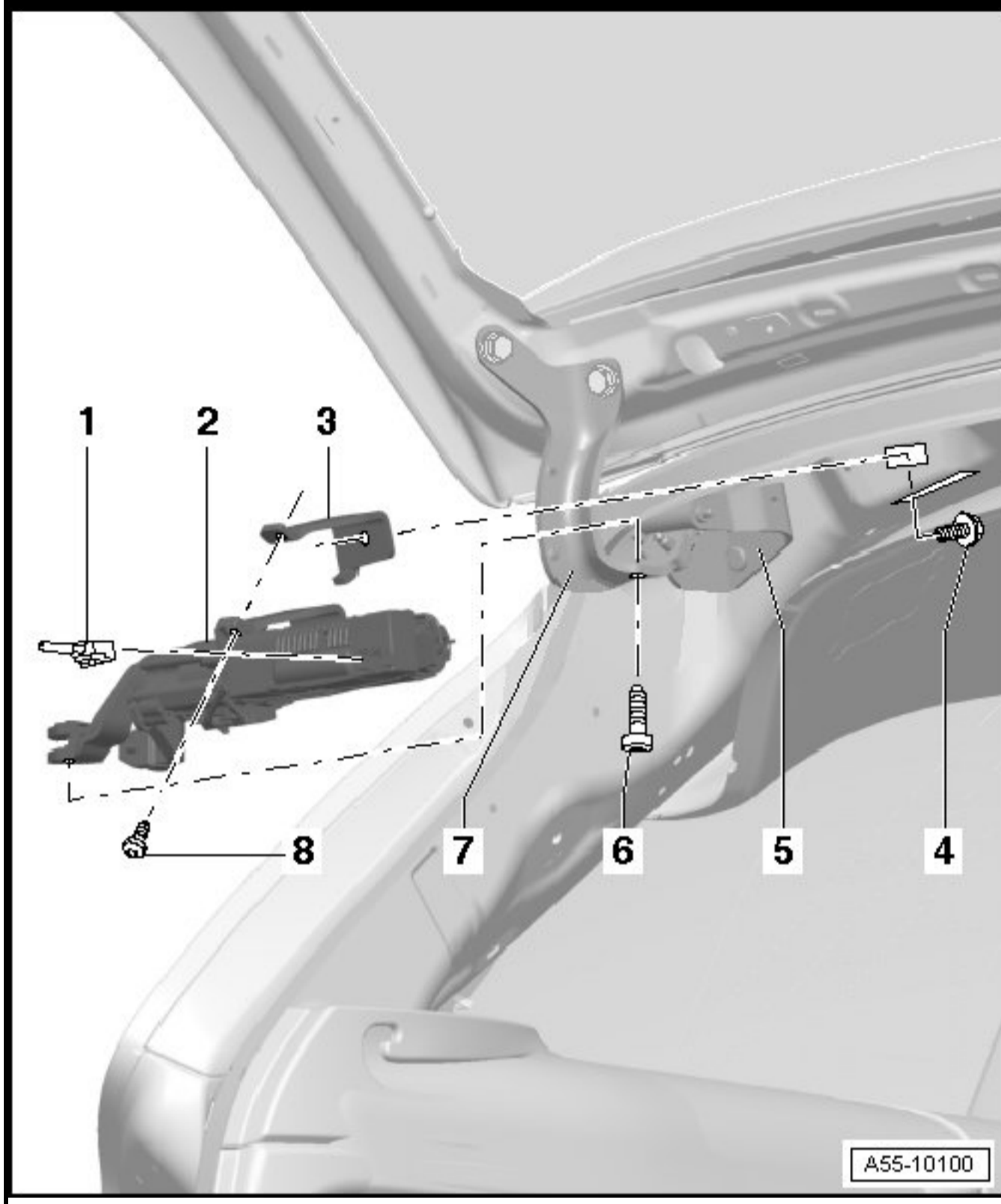

Zoom Sized for Print

1 Connector

- α Remove drive unit before removing.

2

α

α

- α Remove or install drive unit only when rear lid is completely open.

- α Before removing driving unit, loosen lock nuts on eccentric bolts.

α

α

- α Eccentric bolts must sit loosely in hinge arm

Rear Lid Left Drive Unit

Roof panel trim removed..

Loosen D-pillar trim in drive unit area or push carefully to side.

Remove electrical connector - 2 -.

Loosen lock nut on drive unit.

hole.

- ☒ Release tension on eccentric bolts with a brief turn to the right, if necessary.
- ☒ Remove the screw - **8** - on the bracket - **3** -.
- ☒ Remove screw - **6** - on hinge arm and remove drive unit - **2** - from the side.

3 Bracket

- ☒ Bracket is positioned with a device in factory and must not be adjusted.
- ☒ If bracket must be replaced, for example, when doing repairs after an accident, proceed as follows.
 - ☒ Rear lid must be installed with gas-filled struts.
 - ☒ Secure bracket - **3** - lightly with screw - **8** - on drive unit first.
 - ☒ Bracket must still be moveable.
 - ☒ Attach drive unit on rear lid hinge parallel to axle until it comes in contact with motor socket.

Drive unit socket must fit flat against hinge axle collar.

- ☒ Secure bracket on body side with screw - **4** - and tighten to 21 Nm.
- ☒ Tighten bolt - **8** - to 8 Nm.
- ☒ Tighten eccentric bolts with locking nuts to drive unit to 6 Nm.
- ☒ Upon tightening locking nuts, eccentric bolts are braced in hinge with no play.
- ☒ For this reason, you cannot counterhold eccentric bolt hex head with an open end wrench when tightening locking nuts.
- ☒ When removing drive unit, this tension is released with a small turn to the right on eccentric bolt hex head, after you have loosened locking nuts.
 - ☒ Tighten screw - **6** - on drive fork to 12 Nm.

4 Combination Screw

- ☒ 21 Nm

5 Lid Hinge

6 Bolt

- ☒ 12 Nm
- ☒ Screw is self-threading.

7 Hinge Arm

8 Combination Screw

- ☒ 8 Nm

Drive Unit Insulation

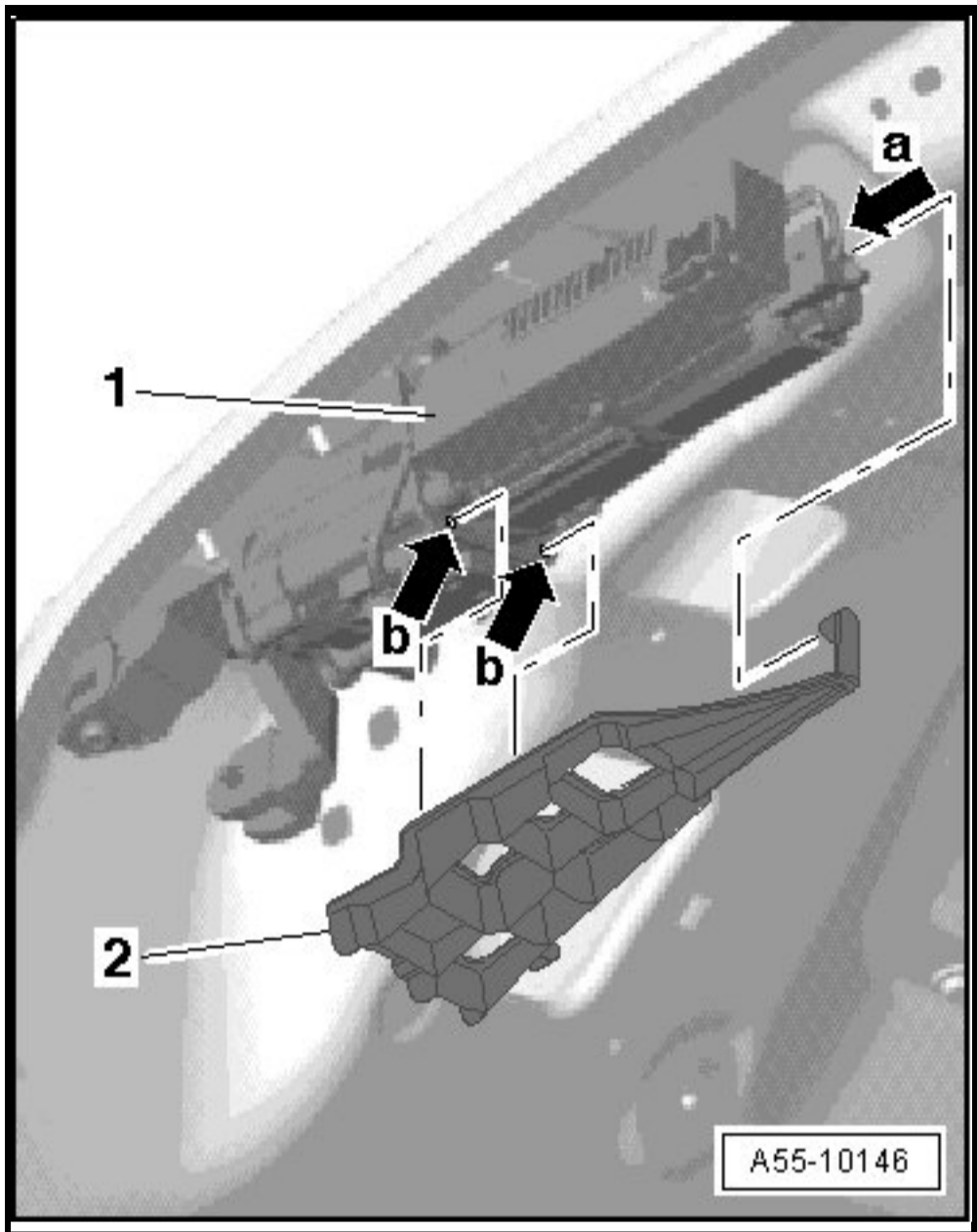

Zoom Sized for Print

⌘ The insulation is only on vehicles with a third row seat bench.

- Slide insulation with mounting pins sideways into mounting cylinder - **arrow a** - and engage in mounting hole - **arrow b** - on drive unit using clips on insulation element.

Install Drive Motor In Hinge

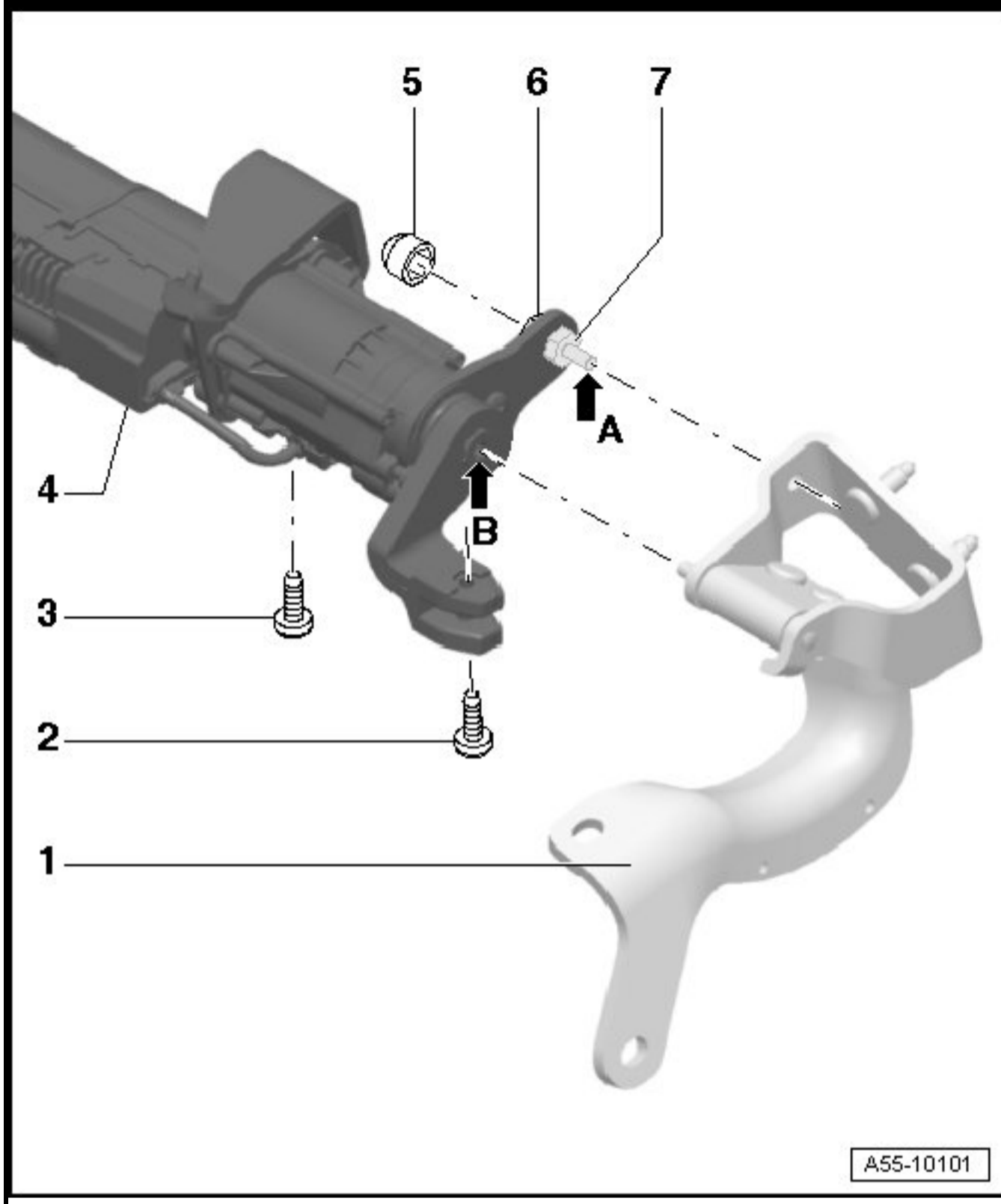

A55-10101

Zoom Sized for Print

1 Lid Hinge

2 Bolt

- ⊠ 8 Nm
- ⊠ Self-threading

3 Combination Screw

- ⊠ 8 Nm

4 Rear Lid Drive Motor

- ⊠ When installing, insert sideways with socket - **arrow B** - and loose eccentric bolts - **arrow A** - in hinge.

- ⊠ Drive unit socket must fit flat against hinge axle collar.

- ⊠ That way, drive unit fork arm engages in hinge arm - **1** -.

- ⌘ Tighten screw - **3** - to secure drive unit to bracket to 8 Nm.
- ⌘ Tighten locking nuts - **6** - to 6 Nm.
- ⌘ Tighten bolt - **2** - to 12 Nm.

5 Cover

- ⌘ Connected to locking nut.

6 Locking Nut

- ⌘ 6 Nm
- ⌘ Before removing drive unit, loosen lock nuts on eccentric bolts.
- ⌘ Release eccentric bolt tension in hinge arm by rotating hex head to right, if necessary.
- ⌘ Self-locking

7 Hex Head Eccentric Bolts

- ⌘ Upon tightening locking nuts, eccentric bolts are braced in hinge with no play.
- ⌘ For this reason, you cannot counterhold eccentric bolt hex head with an open end wrench when tightening locking nuts.
- ⌘ When removing drive unit, this tension is released with a small turn to the right on eccentric bolt hex head, after you have loosened locking nuts.

[Account](#) | [Vehicle](#) | [Help](#) | [Contact](#) | [AutoZone Community](#) | [Exit](#)

© 2015 ALLDATA, LLC. All Rights Reserved. [Trademarks](#) | [Privacy Policy](#) | [Terms and Conditions](#)