

Account

Vehicle

Help

Search

Contact

AutoZone Community

Exit

Your Vehicle: 2010 Audi Q7 Quattro (4LB) V6-3.0L DSL Turbo (CATA)



SAVE \$25
instantly on 4 tires!

tirebuyer.com

SAVE NOW >

SAVE \$25
instantly on 4 tires!

tirebuyer.com

SAVE NOW >

[Vehicle](#) » [Powertrain Management](#) » [Fuel Delivery and Air Induction](#) » [Turbocharger](#) » [Service and Repair](#) » [Turbocharger Overview](#)

Turbocharger Overview

Turbocharger Overview

- ⌘ Pay attention to the rules of cleanliness. Refer to => [Clean Working Conditions] [See: Engine, Cooling and Exhaust\Engine\Service Precautions\Clean Working Conditions.](#)
- ⌘ Before testing or performing a repair, check all air guide pipes and hoses and all vacuum lines for leaks and secure seating.

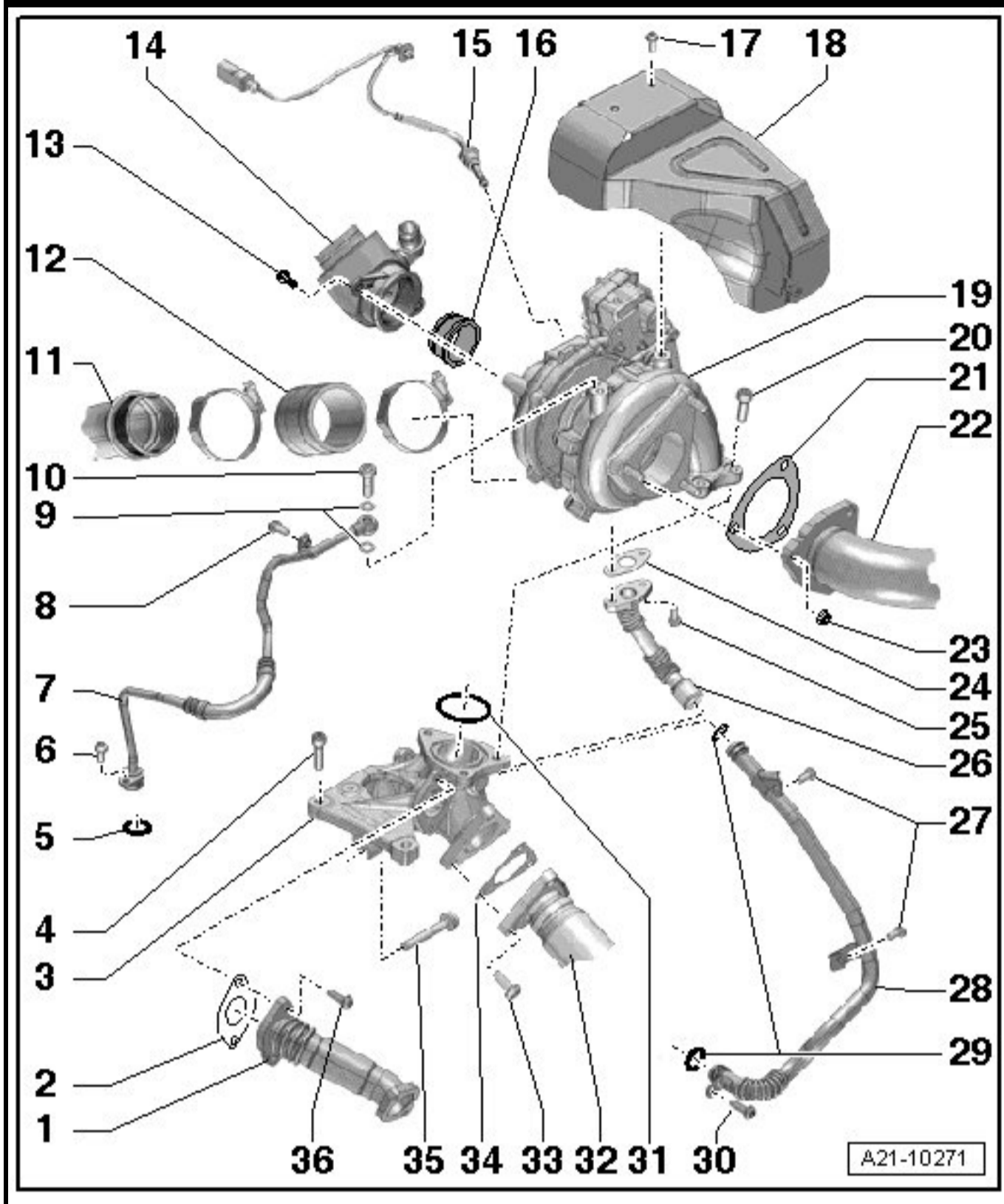

Zoom

Sized for Print

1 Pipe

- ⌘ By-pass valve for the [exhaust gas recirculation](#) auxiliary cooler
- ⌘ With [catalytic converter](#)

2 Gasket

- ⌘ Replace

3 Intermediate Flange

- ⌘ Removing and installing, refer to => [Intermediate Flange] [See: Supercharger\Service and Repair\Intermediate Flange](#)

4 Bolt

- ⌘ 25 Nm

5 O-ring

- ⌘ Replace

6 Bolt

- ⌘ 9 Nm

7 Oil Supply Line

- ⌘ From the cylinder block

8 Bolt

- ⌘ 9 Nm

9 Seals

- ⌘ Replace

10 Banjo Bolt

- ⌘ 15 Nm

11 Right Air Duct Pipe

12 Air Guide Hose

- ⌘ From the turbocharger to the right air duct pipe

13 Bolt

- ⌘ 9 Nm

14 Air Duct Hose Connection

- ⌘ From the Mass Airflow (MAF) sensor (G70) to the turbocharger
- ⌘ Must be free of oil and grease before installing

15 Exhaust Gas Temperature (EGT) Sensor 1 (G235)

- ⌘ Removing and installing, refer to => [Exhaust Gas Temperature Sensor 1 (G235)] [See: Computers and Control Systems\Exhaust Temperature Sensor\Service and Repair\Exhaust Gas Temperature Sensor 1 \(G235\)](#)

16 Seal

- ⌘ Replace if damaged

17 Bolt

- ⌘ 9 Nm

18 Turbocharger Heat Shield

19 Turbocharger

- ⌘ With [turbocharger control module 1 \(J724\)](#)
- ⌘ Removing and installing turbocharger, refer to => [Turbocharger] [See: Turbocharger](#)
- ⌘ [Turbocharger control module 1](#), removing and installing. Refer to => [Turbocharger Control Module 1 (J724)] [See: Turbocharger Control Module\Service and Repair.](#)

20 Bolt

- ⊠ 30 Nm plus an additional 90°turn
- ⊠ Replace
- ⊠ Coat with hot bolt paste; Hot bolt paste, refer to the Parts Catalog

21 Gasket

- ⊠ Replace

22 Primary Catalytic Converter

- ⊠ Removing and installing, refer to => [Primary Catalytic Converter] See: Emission Control Systems\Catalytic Converter\Service and Repair\Primary Catalytic Converter

23 Nut

- ⊠ Tightening specifications - **item 12** - => [(Item 12) Nut] See: Engine, Cooling and Exhaust\Exhaust System\Muffler\Service and Repair

24 Gasket

- ⊠ Replace

25 Bolt

- ⊠ Tighten to 7 Nm
- ⊠ 9 Nm
- ⊠ Coat with hot bolt paste; Hot bolt paste, refer to the Parts Catalog

26 Oil Return Line Upper Section

- ⊠ from turbocharger

27 Bolts

- ⊠ 9 Nm

28 Oil Return Line Lower Section

- ⊠ To cylinder block

29 O-rings

- ⊠ Replace

30 Bolt

- ⊠ 9 Nm

31 Gasket

- ⊠ Replace

32 Intermediate Pipe

- ⊠ Removing and installing, refer to => [Left Intermediate Pipe] See: Engine, Cooling and Exhaust\Exhaust System\Exhaust Pipe\Service and Repair\Left Intermediate Pipe, => [Right Intermediate Pipe] See: Engine, Cooling and Exhaust\Exhaust System\Exhaust Pipe\Service and Repair\Right Intermediate Pipe

33 Bolt

⌵ Tightening specifications - **item 5** - => [(Item 5) Screw] [See: Engine, Cooling and Exhaust\Exhaust System\Exhaust Manifold\Service and Repair\Exhaust Manifold Overview](#)

34 Gasket

⌵ Replace

35 Bolt

⌵ 25 Nm

36 Bolt

⌵ 9 Nm

[Account](#) | [Vehicle](#) | [Help](#) | [Contact](#) | [AutoZone Community](#) | [Exit](#)

© 2015 ALldata, LLC. All Rights Reserved. [Trademarks](#) | [Privacy Policy](#) | [Terms and Conditions](#)